



**REGULAR MEETING MINUTES**

**Date:** 12/5/2017  
**Time:** 7:00 p.m.  
**City Council Chambers**  
**701 Laurel St., Menlo Park, CA 94025**

**A. Call to Order**

Mayor Keith called Regular Session to order at 7:02 p.m.

**B. Roll Call**

**Present:** Cline, Keith, Ohtaki (arrived at 7:11 p.m.), Mueller  
**Absent:** Carlton  
**Staff:** City Manager Alex McIntyre, City Attorney Bill McClure, Deputy City Clerk Jelena Harada

**C. Pledge of Allegiance**

Mayor Keith led the Pledge of Allegiance.

Mayor Keith recognized the recent passing of community leader Ernst Meissner.

**D. Public Comment**

- Angela Evans, San Mateo County Housing Leadership Council, spoke about the recent On the Table event discussions about housing.

Mayor Pro Tem Ohtaki joined the meeting at 7:11 p.m.

- Angela Evans spoke about housing in Menlo Park.
- Amina Burrell, HIP Housing, spoke about HIP Housing programs in Menlo Park.
- Andrew Boone spoke about approval of El Camino Corridor Transportation Plan in Redwood City.
- Katie Behroozi spoke in memory of Ernst Meissner.
- Jen Wolosin spoke about district elections advisory committee and main library siting meeting.

**E. Presentations and Proclamations**

- E1. Presentation on recycled water by West Bay Sanitary District staff

West Bay Sanitary District Board President Ned Moritz made brief comments. City Engineer Azalea Mitch introduced the item and consultant Dave Richardson of Woodard and Corran made a presentation.

**F. Commissioner Reports**

Mayor Keith announced that Commissioner Reports items F1 and F2 were being continued to a future meeting in January 2018.

## **G. Consent Calendar**

- G1. Adopt an ordinance amending Chapter 5.69 of the Menlo Park Municipal Code to reauthorize Public, Education, and Government (PEG) access fees that apply to AT&T and Comcast under their respective State video franchises (Staff Report #17-307-CC)
- G2. Adopt a resolution approving the City Council Community Funding Subcommittee's recommendations regarding the 2017-18 community funding allocation (Staff Report #17-299-CC)
- G3. Adopt a resolution accepting fiscal year 2017-2018 State Supplemental Local Law Enforcement Grant (COPS Frontline) in the amount of \$100,000; and approve a spending plan (Staff Report #17-302-CC)
- G4. Reject all bids for the Sand Hill Reservoir Mixer Installation Project (Staff Report #17-301-CC)
- G5. Adopt a resolution of support for and authorization to submit an application for Measure A Pedestrian and Bicycle Program funding for the Menlo Park Bicycle and Pedestrian Enhancement Project and if awarded, authorize the City Manager to enter into necessary funding agreements to accept the funds (Staff Report #17-293-CC)
- G6. Approve the settlement agreement between the City of Menlo Park and the City of East Palo Alto (Staff Report #17-305-CC)
- G7. Accept the City Council meeting minutes for May 23, October 17, 2017 (Attachment)

Councilmember Mueller pulled items G2 and G5. Mayor Pro Tem Ohtaki pulled item G1.

**ACTION:** Motion and second (Ohtaki/Keith) to approve all items on the Consent Calendar, except G1, G2, and G5, passed 4-0-1 (Carlton absent).

**ACTION:** Motion and second (Ohtaki/Keith) to approve item G1, passed 4-0-1 (Carlton absent).

**ACTION:** Motion and second (Cline/Mueller) to approve recommended funding for CORA (Community Overcoming Relationship Abuse), Legal Aid San Mateo County, and Service League of San Mateo County, passed 3-0-1-1 (Keith abstained, Carlton absent).

**ACTION:** Motion and second (Cline/Ohtaki) to approve recommended funding for Life Moves passed 3-0-1-1 (Mueller abstained, Carlton absent).

**ACTION:** Motion and second (Cline/Ohtaki) to approve recommended funding for the remainder of the items passed 4-0-1 (Carlton absent).

**ACTION:** Motion and second (Keith/Mueller) to adopt a resolution of support for and authorization to submit an application for Measure A Pedestrian and Bicycle Program funding for the Menlo Park Bicycle and Pedestrian Enhancement Project with addition (if possible) of the installation of sidewalks along Sharon Road between Alameda de las Pulgas and La Entrada School, and if awarded, authorize the City Manager to enter into necessary funding agreements to accept the funds. The motion passed 4-0-1 (Carlton absent).

## H. Regular Business

- H1. Adopt a resolution authorizing the installation of temporary traffic calming modifications to the Willows neighborhood due to construction impacts of the Willow Road/US 101 interchange; and appropriate \$275,000 from the Measure A fund for the Bayfront Expressway, Willow Road, and Marsh Road adaptive signal timing project (Staff Report #17-294-CC)

Assistant City Manager Chip Taylor introduced the item. Senior Transportation Engineer Angela Obeso, Police Commander Dave Bertini and Assistant Public Works Director Nicole Nagaya made a presentation.

- Josh Spira spoke about traffic on Willow Road.
- Daniel Hom spoke about traffic on Willow Road.
- Brian Gilmer spoke about traffic in the Willows neighborhood.
- Joss Geiduschek spoke about traffic on Willow Road.
- Chris Andrews spoke about traffic in the Willows neighborhood.
- Fran Dehn, Menlo Park Chamber of Commerce, spoke about traffic concerns for Willows neighborhood businesses.
- Amar Murugan spoke in support of the recommended traffic calming modifications.
- Sherri Sager, Lucile Packard Children's Hospital, spoke about traffic concerns for Willows neighborhood businesses.
- Thomas Burg spoke about traffic in the Willows neighborhood.
- Tom Caldecott spoke about spoke about traffic in the Willows neighborhood.
- Tracy Morris spoke about traffic in the Willows neighborhood.
- Chris DeCardy spoke about traffic in the Willows neighborhood.
- Stephanie Zeller spoke about traffic in the Willows neighborhood.
- Brie Cioffi spoke about traffic in the Willows neighborhood.
- Paul Montgomery spoke about traffic in the Willows neighborhood.
- Amy Roleder spoke about traffic in the Willows neighborhood.
- Rocio Wellington spoke about traffic in the Willows neighborhood.
- Judy Rocchio spoke about traffic in the Willows neighborhood.
- Chitra Chakravarthy spoke about traffic in the Willows neighborhood.
- Penelope Huang spoke about traffic in the Willows neighborhood.
- Jen Wolosin, Parents for Safe Routes, spoke about student safety concerns.
- Lisa Ratner spoke about traffic in the area.
- Tricia Barr spoke about traffic in the Willows neighborhood.
- Mike Frank spoke about traffic in the Willows neighborhood.

**ACTION:** Motion and second (Ohtaki/Mueller) to adopt a resolution authorizing the installation of temporary traffic calming modifications in the Willows neighborhood as identified in the staff report with the addition of no right turn signs from Durham Street onto Willow Road; to delegate authority to staff to make adjustments/changes to these new adopted restrictions as needed; and to appropriate \$275,000 from the Measure A fund for the Bayfront Expressway, Willow Road, and Marsh Road adaptive signal timing project. The motion passed 4-0-1 (Carlton absent).

- H2. Authorize the City Manager to submit a list of transportation projects to be considered for inclusion in the *Get Us Moving* San Mateo County Expenditure Plan (Staff Report #17-303-CC)

Assistant Public Works Director Nicole Nagaya made a presentation.

- Andrew Boone spoke against including the roadway grade separations on Bayfront Expressway.
- Adina Levin spoke about transportation management programs.

**ACTION:** Motion and second (Ohtaki/Mueller) to authorize the City Manager to submit a list of transportation projects to be considered for inclusion in the Get Us Moving San Mateo County Expenditure Plan, with the addition of a transportation demand management component. The motion passed 4-0-1 (Carlton absent).

H3. Authorize submittal of a comment letter on the Final Dumbarton Transportation Corridor Study (Staff Report #17-295-CC)

Assistant Public Works Director Nicole Nagaya provided the staff report.

- Adina Levin spoke about traffic data related to Dumbarton Bridge traffic.
- Andrew Boone spoke about transportation demand management and a multi-use trail.
- Diane Bailey, Menlo Spark, spoke about transportation demand management and a multi-use trail.

**ACTION:** Motion and second (Keith/Cline) to authorize submittal of a comment letter on the Final Dumbarton Transportation Corridor Study with the addition of a transportation demand management component. The motion passed 4-0-1 (Carlton absent).

H4. Approve the 2018 City Council meeting schedule (Staff Report #17-304-CC)

Interim City Clerk Clay Curtin provided the staff report.

**ACTION:** Motion and second (Ohtaki/Keith) to approve the 2018 City Council meeting schedule as amended, passed 4-0-1 (Carlton absent).

H5. Discussion and direction on next steps for addressing complaints related to unregulated and unmaintained newsracks in Menlo Park (Staff Report #17-292-CC)

Management Analyst Meghan Revolinsky made a presentation.

- Fran Dehn, Menlo Park Chamber of Commerce, spoke about unregulated newsracks in Menlo Park.

City Council gave direction to staff to draft an ordinance and bring it for City Council consideration after it has been vetted through a stakeholders' advisory group.

H6. Approve a resolution to amend the City's salary schedule effective December 10, 2017 (Staff Report #17-298-CC)

Administrative Services Director Nick Pegueros provided the staff report.

**ACTION:** Motion and second (Ohtaki/Cline) to approve a resolution to amend the City's salary schedule effective December 10, 2017, passed 4-0-1 (Carlton absent).



**I. Informational Items**

- I1. El Camino Real/Downtown Specific Plan-Maximum Allowable Development  
(Staff Report #17-300-CC)

Assistant Community Development Director Mark Muenzer answered questions from the City Council.

- Adina Levin spoke about housing needs.

- I2. Update on bus shelter installations in Belle Haven (Staff Report #17-296-CC)
- I3. 3rd Quarter Update on 2017 City Council Work Plan (Staff Report #17-306-CC)

**J. City Manager's Report**

There was no report.

**K. Councilmember Reports**

Mayor Pro Tem Ohtaki announced that he and Councilmember Mueller will be presenting to the Menlo Park City School District Board regarding Stanford developments on December 12.

**L. Adjournment**

Mayor Keith adjourned the meeting at 12:18 a.m. on December 6, 2017.

These minutes were accepted at the City Council meeting of December 12, 2017.

# WILLOW – U.S. 101 CONSTRUCTION

Construction Update and Neighborhood Traffic Options

City Council, December 5, 2017



ANNIEERGA FAMILY  
GYMNASIUM

## PROJECT NEED

- Short merges
- Insufficient vehicle storage
- Need for improved bicycle and pedestrian safety and access

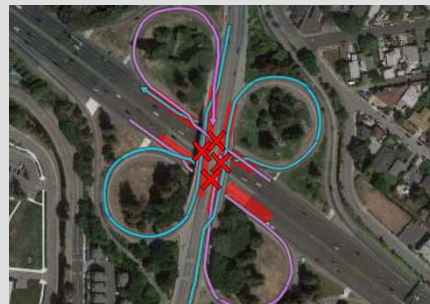

## CONSTRUCTION SCHEDULE & IMPACTS

- PG&E utility relocations – Completed October 2017
- Caltrans construction (May 8, 2017 – early 2019)
  - Phase 1 completed early November 2017
  - Phase 2 begun early November 2017
    - Anticipated duration 6 months
  - Phase 3 expected to begin May 2018
    - Anticipated duration 6 months
  - Phase 4 expected to begin November 2018
    - Anticipated duration 2 months



## PHASE 2 CHANGES & IMPACTS

- Temporary traffic signals
- Shift ramps, open up work zones
- Change in lane assignments
- Begin new ramp construction
- Begin demo of outside of existing bridge
- Begin construction of outside of new bridge
- Replace sound walls



3. CONSTRUCT 101 NB OFF-RAMP ALONG "SER1" LINE AND NB 101 ON-RAMP ALONG "SEL1" LINE UP TO 0.15' BELOW FINISHED GRADE FROM "SER1" 10+00 TO 19+20; "SEL1" 17+00 TO 20+80, INCLUDING EMBANKMENT, 4-CONCRETE BOX CULVERT AND OTHER DRAINAGE SYSTEMS, SOUND WALL 1, RETAINING WALLS 1 AND 2.

4. CONSTRUCT NORTHBOUND PORTION OF WILLOW Rd PAVEMENT "WR1" 21+83 TO 26+76 AND MATCH TO EXISTING WILLOW Rd PAVEMENT.

5. INSTALL NORTHBOUND OVERHEAD SIGN AT S+D "D2" 236+60. AFTER INSTALLATION OF THE NEW OVERHEAD SIGN, REMOVE EXISTING OVERHEAD SIGN AT S+D "D2" 231+00.

6. CONSTRUCT 101 SB OFF-RAMP ALONG "NWR1" LINE AND 101 SB ON-RAMP ALONG "NWL1" LINE UP TO 0.15' BELOW FINISHED GRADE FROM "NWR1" 10+18 TO 18+20; "NWL1" 13+95 TO 16+80, INCLUDING EMBANKMENT, SOUND WALL 3 AND RETAINING WALL 4.

7. INSTALL SOUTHBOUND OVERHEAD SIGN AT S+D "D2" 211+60. AFTER INSTALLATION OF THE NEW OVERHEAD SIGN, REMOVE EXISTING OVERHEAD SIGN AT S+D "D2" 215+50.

8. CONSTRUCT SB PORTION OF WILLOW Rd PAVEMENT "WR1" 12+50 TO 14+50 AND MATCH WILLOW Rd PAVEMENT.

9. OBLITERATE SURFACE OF EXISTING ON/OFF RAMP.

10. AT THE INTERSECTION FROM "SER1" 19+20 TO 21+56; "SEL1" 20+80 TO 22+80 THE NEW PAVEMENT IS TEMPORARY (DETOUR C) AND HAS TO MATCH TO THE EXISTING NORTHBOUND WILLOW ROAD PAVEMENT. FOR DETAILS, SEE SHEET SCD-6.

11. AT THE INTERSECTION FROM "NWR1" 18+20 TO 22+21; "NWL1" 10+25 TO 13+95 THE NEW PAVEMENT IS TEMPORARY (DETOUR D) AND HAS TO MATCH TO THE EXISTING SOUTHBOUND WILLOW ROAD PAVEMENT. FOR DETAILS, SEE SHEET SCD-7.

12. REMOVE AND CONSTRUCT CURBS ALONG FREEWAY SIDE OF FRONTAGE ROAD ON E BAYSHORE ROAD.

13. REMOVE AND CONSTRUCT CURBS ALONG FREEWAY SIDE OF FRONTAGE ROAD ON VAN BUREN ROAD AND BAY ROAD.

14. CEMENT DEEP SOIL MIXING WILL BE DONE IN THIS STAGE, SEE SHEET C-17.

**TRAFFIC**

1. CLOSE 101 NB AND 101 SB DIAGONAL OFF-RAMP.
2. CLOSE 101 NB AND 101 SB ON-RAMP.
3. OPEN 101 NB TEMPORARY LOOP OFF-RAMP ALONG DETOUR A AND 101 SB TEMPORARY LOOP OFF-RAMP ALONG DETOUR B.
4. OPEN 101 NB DIAGONAL ON-RAMP ALONG DETOUR A FOR NB WILLOW Rd TRAFFIC.
5. OPEN 101 SB DIAGONAL ON-RAMP ALONG DETOUR B FOR SB WILLOW Rd TRAFFIC.

**2** REPLACED PER ADDENDUM No. 2 DATED NOVEMBER 30, 2016

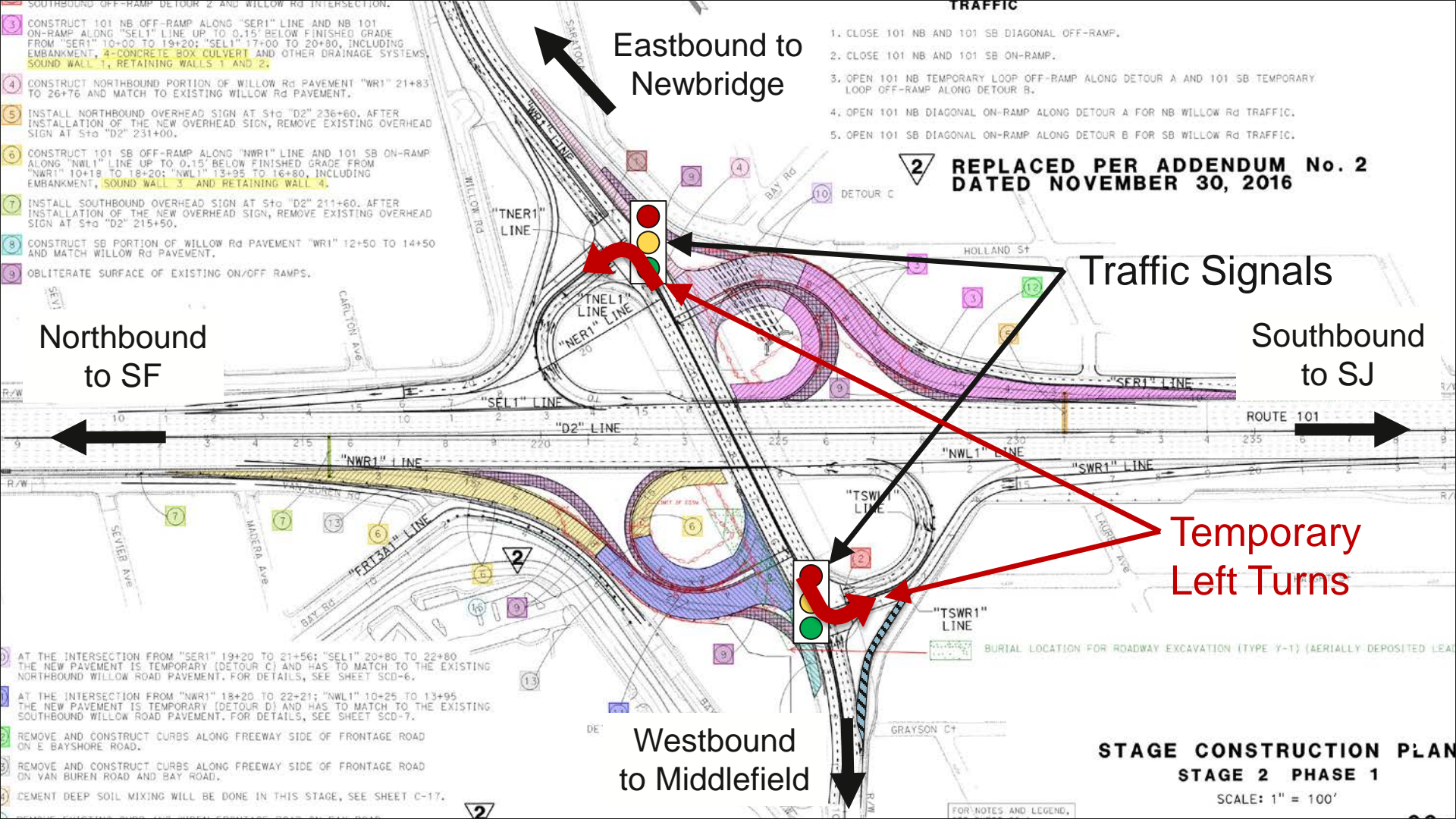

Eastbound to Newbridge

Northbound to SF

Traffic Signals

Southbound to SJ

Temporary Left Turns

Westbound to Middlefield

**STAGE CONSTRUCTION PLAN**  
**STAGE 2 PHASE 1**

SCALE: 1" = 100'

FOR NOTES AND LEGEND,



- 3. CONSTRUCT 101 NB OFF-RAMP ALONG "SER1" LINE AND NB 101 ON-RAMP ALONG "SEL1" LINE UP TO 0.15' BELOW FINISHED GRADE FROM "SER1" 10+00 TO 19+20; "SEL1" 17+00 TO 20+80, INCLUDING EMBANKMENT, 4-CONCRETE BOX CULVERT AND OTHER DRAINAGE SYSTEMS, SOUND WALL 1, RETAINING WALLS 1 AND 2.
- 4. CONSTRUCT NORTHBOUND PORTION OF WILLOW Rd PAVEMENT "WR1" 21+83 TO 26+76 AND MATCH TO EXISTING WILLOW Rd PAVEMENT.
- 5. INSTALL NORTHBOUND OVERHEAD SIGN AT S+D "D2" 236+60. AFTER INSTALLATION OF THE NEW OVERHEAD SIGN, REMOVE EXISTING OVERHEAD SIGN AT S+D "D2" 231+00.
- 6. CONSTRUCT 101 SB OFF-RAMP ALONG "NWR1" LINE AND 101 SB ON-RAMP ALONG "NWL1" LINE UP TO 0.15' BELOW FINISHED GRADE FROM "NWR1" 10+18 TO 18+20; "NWL1" 13+95 TO 16+80, INCLUDING EMBANKMENT, SOUND WALL 3 AND RETAINING WALL 4.
- 7. INSTALL SOUTHBOUND OVERHEAD SIGN AT S+D "D2" 211+60. AFTER INSTALLATION OF THE NEW OVERHEAD SIGN, REMOVE EXISTING OVERHEAD SIGN AT S+D "D2" 215+50.
- 8. CONSTRUCT SB PORTION OF WILLOW Rd PAVEMENT "WR1" 12+50 TO 14+50 AND MATCH WILLOW Rd PAVEMENT.
- 9. OBLITERATE SURFACE OF EXISTING ON/OFF RAMP.

- TRAFFIC**
1. CLOSE 101 NB AND 101 SB DIAGONAL OFF-RAMP.
  2. CLOSE 101 NB AND 101 SB ON-RAMP.
  3. OPEN 101 NB TEMPORARY LOOP OFF-RAMP ALONG DETOUR A AND 101 SB TEMPORARY LOOP OFF-RAMP ALONG DETOUR B.
  4. OPEN 101 NB DIAGONAL ON-RAMP ALONG DETOUR A FOR NB WILLOW Rd TRAFFIC.
  5. OPEN 101 SB DIAGONAL ON-RAMP ALONG DETOUR B FOR SB WILLOW Rd TRAFFIC.

**2** REPLACED PER ADDENDUM No. 2 DATED NOVEMBER 30, 2016

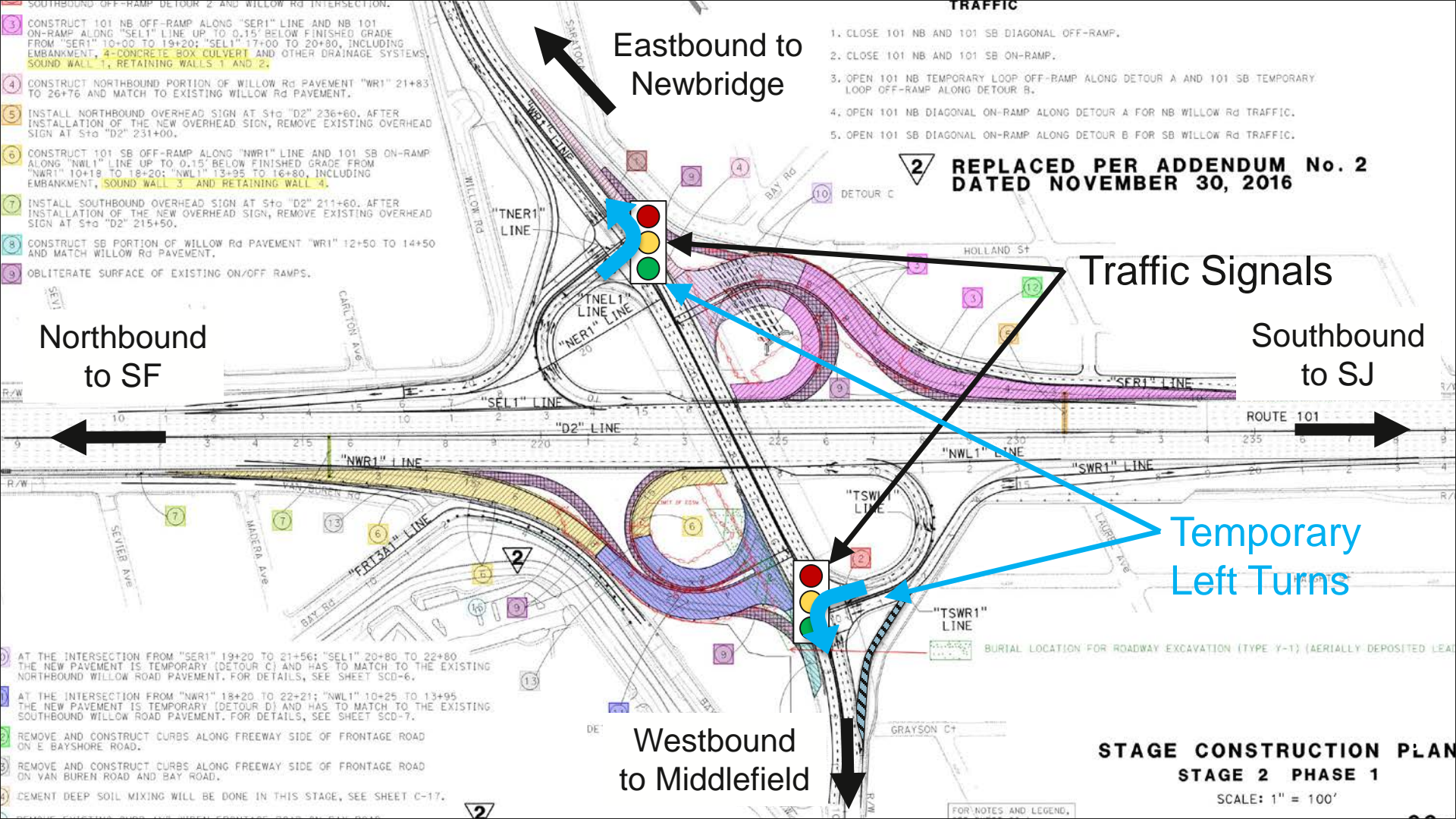

Eastbound to Newbridge

Northbound to SF

Traffic Signals

Southbound to SJ

Temporary Left Turns

Westbound to Middlefield

**STAGE CONSTRUCTION PLAN**  
**STAGE 2 PHASE 1**  
 SCALE: 1" = 100'



**ARK**

Eastbound to  
Newbridge

Northbound  
to SF

Southbound  
to SJ

**MENLO PARK**

Westbound  
to Middlefield





- 3. CONSTRUCT 101 NB OFF-RAMP ALONG "SER1" LINE AND NB 101 ON-RAMP ALONG "SEL1" LINE UP TO 0.15' BELOW FINISHED GRADE FROM "SER1" 10+00 TO 19+20; "SEL1" 17+00 TO 20+80, INCLUDING EMBANKMENT, 4-CONCRETE BOX CULVERT AND OTHER DRAINAGE SYSTEMS, SOUND WALL 1, RETAINING WALLS 1 AND 2.
- 4. CONSTRUCT NORTHBOUND PORTION OF WILLOW Rd PAVEMENT "WR1" 21+83 TO 26+76 AND MATCH TO EXISTING WILLOW Rd PAVEMENT.
- 5. INSTALL NORTHBOUND OVERHEAD SIGN AT S+D "D2" 236+60. AFTER INSTALLATION OF THE NEW OVERHEAD SIGN, REMOVE EXISTING OVERHEAD SIGN AT S+D "D2" 231+00.
- 6. CONSTRUCT 101 SB OFF-RAMP ALONG "NWR1" LINE AND 101 SB ON-RAMP ALONG "NWL1" LINE UP TO 0.15' BELOW FINISHED GRADE FROM "NWR1" 10+18 TO 18+20; "NWL1" 13+95 TO 16+80, INCLUDING EMBANKMENT, SOUND WALL 3 AND RETAINING WALL 4.
- 7. INSTALL SOUTHBOUND OVERHEAD SIGN AT S+D "D2" 211+60. AFTER INSTALLATION OF THE NEW OVERHEAD SIGN, REMOVE EXISTING OVERHEAD SIGN AT S+D "D2" 215+50.
- 8. CONSTRUCT SB PORTION OF WILLOW Rd PAVEMENT "WR1" 12+50 TO 14+50 AND MATCH WILLOW Rd PAVEMENT.
- 9. OBLITERATE SURFACE OF EXISTING ON/OFF RAMPS.

- TRAFFIC**
1. CLOSE 101 NB AND 101 SB DIAGONAL OFF-RAMP.
  2. CLOSE 101 NB AND 101 SB ON-RAMP.
  3. OPEN 101 NB TEMPORARY LOOP OFF-RAMP ALONG DETOUR A AND 101 SB TEMPORARY LOOP OFF-RAMP ALONG DETOUR B.
  4. OPEN 101 NB DIAGONAL ON-RAMP ALONG DETOUR A FOR NB WILLOW Rd TRAFFIC.
  5. OPEN 101 SB DIAGONAL ON-RAMP ALONG DETOUR B FOR SB WILLOW Rd TRAFFIC.

**2** REPLACED PER ADDENDUM No. 2 DATED NOVEMBER 30, 2016

Northbound to SF

Eastbound to Newbridge

Southbound to SJ

Westbound to Middlefield

**STAGE CONSTRUCTION PLAN**  
**STAGE 2 PHASE 1**

SCALE: 1" = 100'

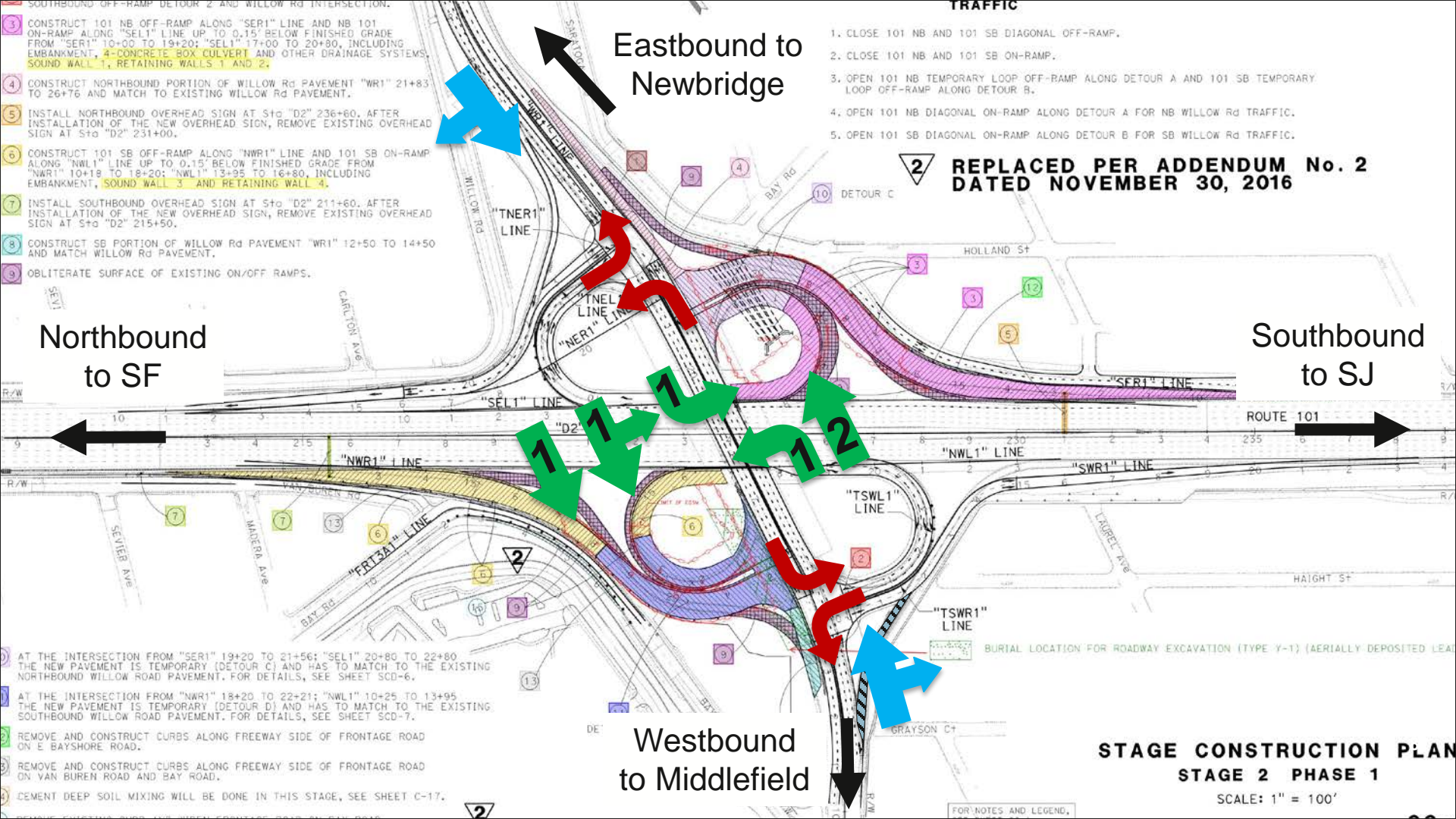

- 10. AT THE INTERSECTION FROM "SER1" 19+20 TO 21+56; "SEL1" 20+80 TO 22+80 THE NEW PAVEMENT IS TEMPORARY (DETOUR C) AND HAS TO MATCH TO THE EXISTING NORTHBOUND WILLOW ROAD PAVEMENT. FOR DETAILS, SEE SHEET SCD-6.
- 11. AT THE INTERSECTION FROM "NWR1" 18+20 TO 22+21; "NWL1" 10+25 TO 13+95 THE NEW PAVEMENT IS TEMPORARY (DETOUR D) AND HAS TO MATCH TO THE EXISTING SOUTHBOUND WILLOW ROAD PAVEMENT. FOR DETAILS, SEE SHEET SCD-7.
- 12. REMOVE AND CONSTRUCT CURBS ALONG FREEWAY SIDE OF FRONTAGE ROAD ON E BAYSHORE ROAD.
- 13. REMOVE AND CONSTRUCT CURBS ALONG FREEWAY SIDE OF FRONTAGE ROAD ON VAN BUREN ROAD AND BAY ROAD.
- 14. CEMENT DEEP SOIL MIXING WILL BE DONE IN THIS STAGE, SEE SHEET C-17.

FOR NOTES AND LEGEND,



# US 101/WILLOW ROAD INTERCHANGE PROJECT

## ALTERNATIVE 1B MODIFIED- CONDENSED PARTIAL CLOVERLEAF

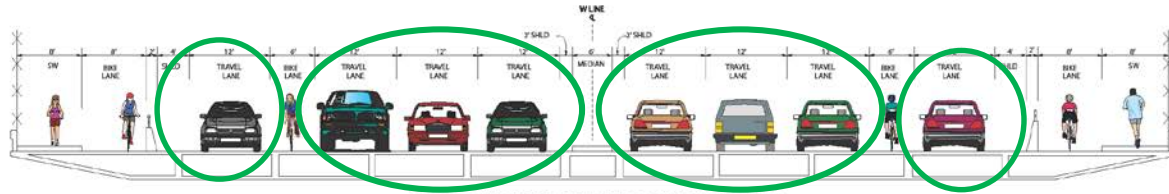

PROPOSED WILLOW ROAD OVERCROSSING

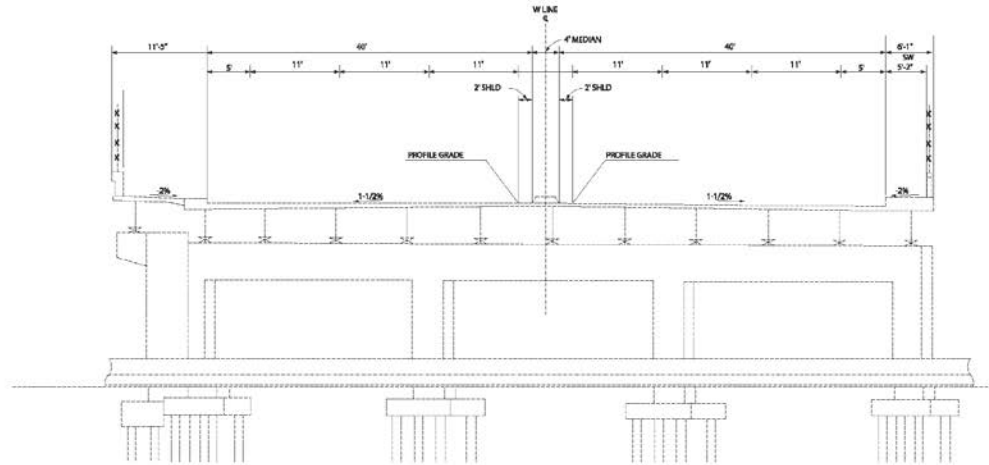

EXISTING WILLOW RD OVERCROSSING

### TYPICAL CROSS SECTIONS



# US 101/WILLOW ROAD INTERCHANGE PROJECT

## ALTERNATIVE 1B MODIFIED- CONDENSED PARTIAL CLOVERLEAF

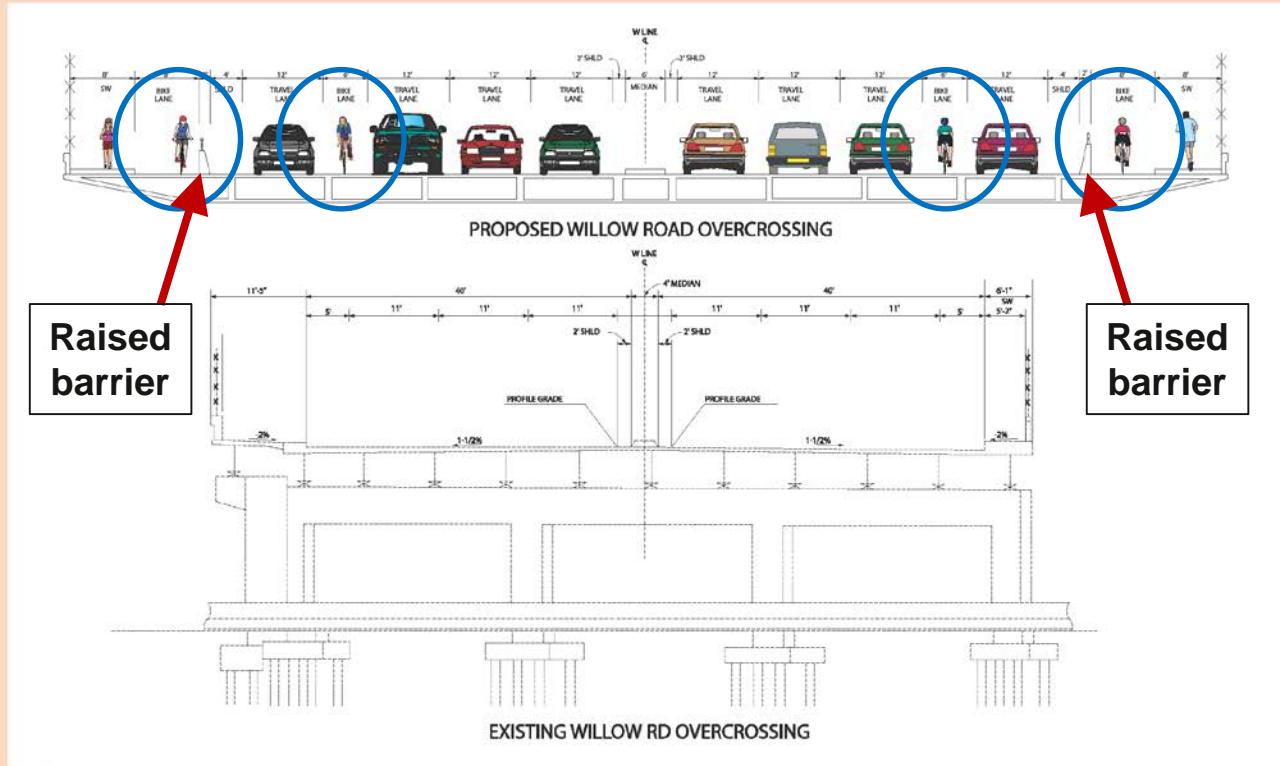

**Raised barrier**

**Raised barrier**

**TYPICAL CROSS SECTIONS**

## EXISTING CONGESTION

- Willows neighborhood studies in 1990's and 2011
- Middlefield-Willow intersection modifications
- San Francisquito Creek Bridge Replacement project
- Marmona Neighborhood Traffic Management Plan (NTMP)
- Clarke Ave-101 Bicycle/Pedestrian Overcrossing



## CURRENT CONDITIONS

- Delays on Willow
- Congestion in neighborhoods
- Cut-through traffic
- Afternoon peak commute



## WILLOW-101 PHASE 2 EFFORTS TO DATE

- Signals activated, new traffic patterns
- Construction Update to Council
- Yellow advisory “No Thru Traffic” signs installed
- Police increased presence and enforcement
- Updated signal timing, on-going adjustments
- Yellow signs replaced with white regulatory “No Thru Traffic” signs
- Electronic signs placed to recommend alternative routes
- Informational Item to Council
- Met on site with Caltrans Deputy Director and construction staff
- Caltrans installing additional warning signs
- Caltrans installing reflective striping
- Additional options to Council for consideration



# POLICE DEPARTMENT ACTIONS



## ■ Higher Visibility and Enforcement

- Two Police Officers assigned to the area Monday-Friday from 3:00-7:00 pm primarily for traffic enforcement and calming
- Two Parking Enforcement Officers redeployed from Downtown area to Willows area for visibility and traffic control if necessary
- Radar trailer speed signs placed throughout the Willows neighborhood based on community complaints
- Police vehicles parked at strategic locations in the Willows neighborhood

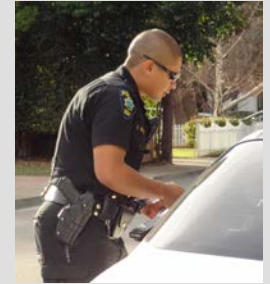

## MOST COMMON CONCERNS HEARD

- On Willow Road
  - Signals causing backups
  - Signals not coordinated
  - Difficult to determine which lane to be in
  - Caught in left turn lane
- In Neighborhoods
  - Cannot access Willow from side streets
  - Backups on Chester, Durham and O’Keefe streets to Menalto
  - Cannot get to homes
  - Cars traveling wrong way

## OPTIONS CONSIDERED AND SUGGESTIONS HEARD

- **Current Efforts**
  - No Thru Traffic signs in neighborhood
  - Signal coordination
  - Increased police presence and enforcement
  - Coordinate with mapping apps
- **Recommendations**
  - Turn restrictions
  - No Outlet/No Willow Access signs
  - Keep Clear/Do not block intersection on Willow
- **Require Study**
  - Residential Placards/Permits
  - Street closures
  - One way streets





# RECOMMENDATIONS



# U.S. 101

# Willow

# Middlefield

- Short-Term Recommendations**  
(All turn restrictions are weekdays from 3-7pm)
-  No Right Turn-onto Willow from O'Keefe and Chester
  -  No Right Turn-onto Willow from Durham on Red
  -  No Left Turn from Woodland to Baywood
  -  KEEP CLEAR- On Willow at O'Keefe, Durham and Chester
  -  No access to Willow on Chester at Laurel
  -  No access to Willow on Chester at Menalta
  - Legend**
  -  Existing Do Not Enter
  -  Existing Traffic Circle
  -  Existing Speed Hump
  -  Existing Stop Signs
  -  City Limits

Proposed Painted Bulb-Out

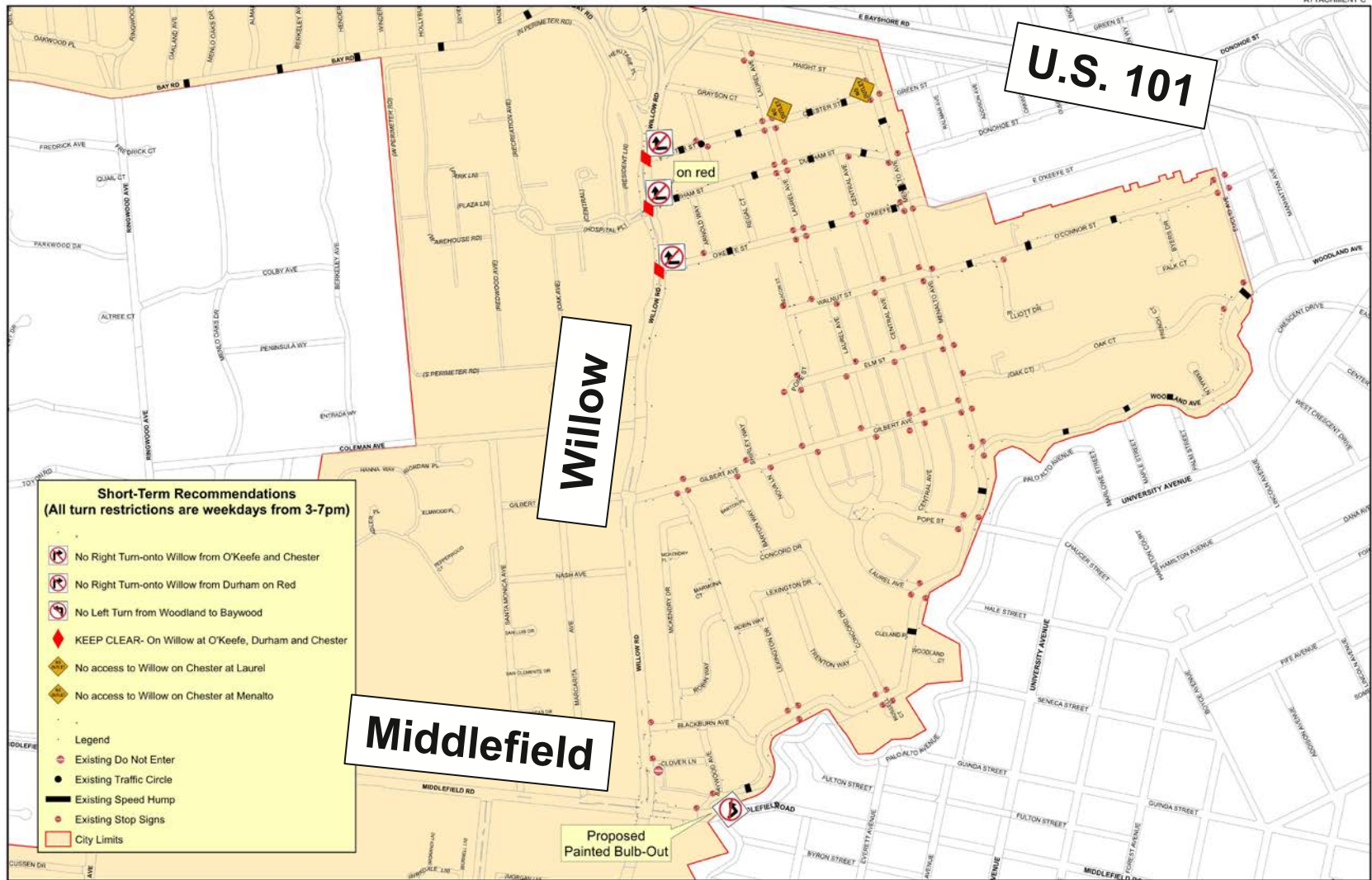

### Short-Term Recommendations (All turn restrictions are weekdays from 3-7pm)

- No Right Turn-onto Willow from O'Keefe and Chester
- No Right Turn-onto Willow from Durham on Red
- No Left Turn from Woodland to Baywood
- KEEP CLEAR- On Willow at O'Keefe, Durham and Chester
- No access to Willow on Chester at Laurel
- No access to Willow on Chester at Menalto

Legend

- Existing Do Not Enter
- Existing Traffic Circle
- Existing Speed Hump
- Existing Stop Signs
- City Limits

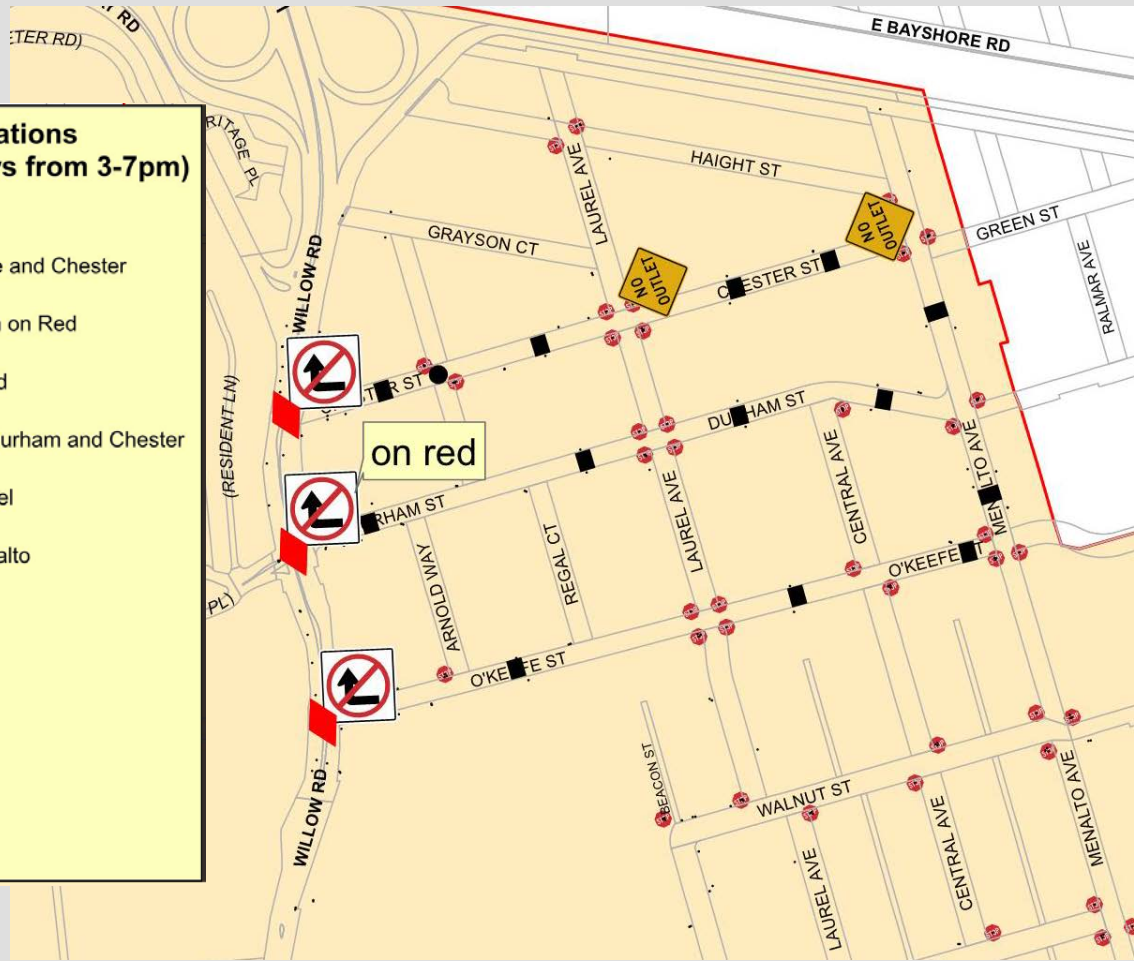

## Short-Term Recommendations (All turn restrictions are weekdays from 3-7pm)





-  No Right Turn-onto Willow from O'Keefe and Chester
-  No Right Turn-onto Willow from Durham on Red
-  No Left Turn from Woodland to Baywood

 KEEP CLEAR- On Willow at O'Keefe, Durham and Chester

 No access to Willow on Chester at Laurel

 No access to Willow on Chester at Menalto

### Legend

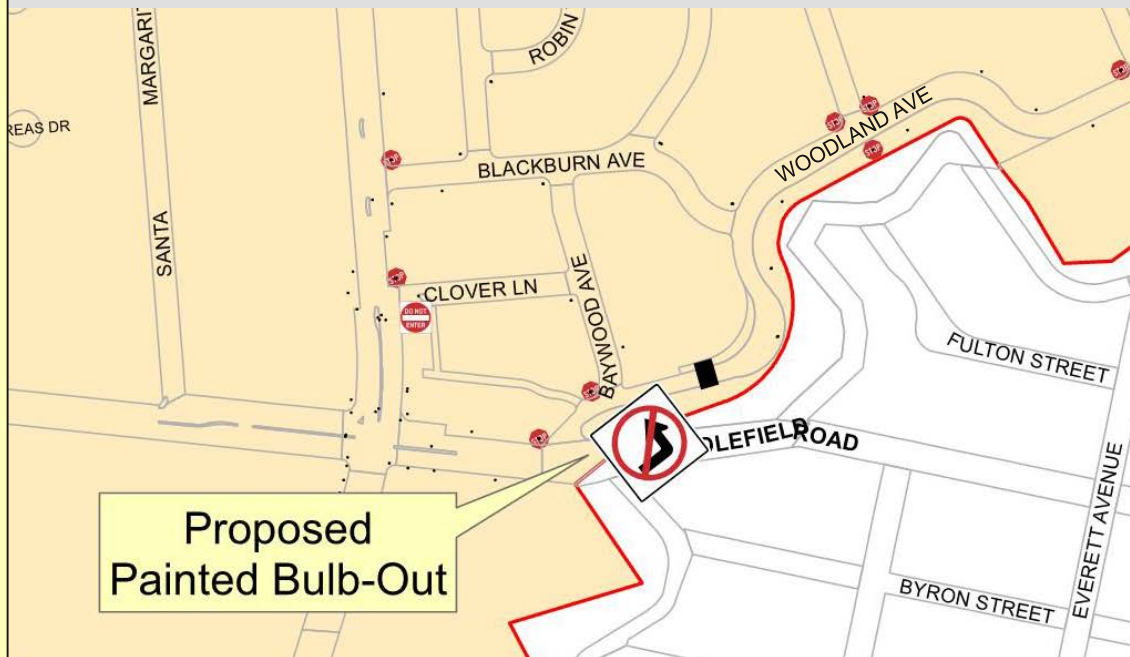

-  Existing Do Not Enter
-  Existing Traffic Circle
-  Existing Speed Hump
-  Existing Stop Signs
-  City Limits



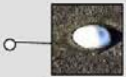

Conceptual Design Only  
Not to scale

Legend

-  A circular marker with a blue and white gradient, likely representing a specific design element or data point.
-  A triangular marker with a vertical bar extending from its base, likely representing a different design element or data point.

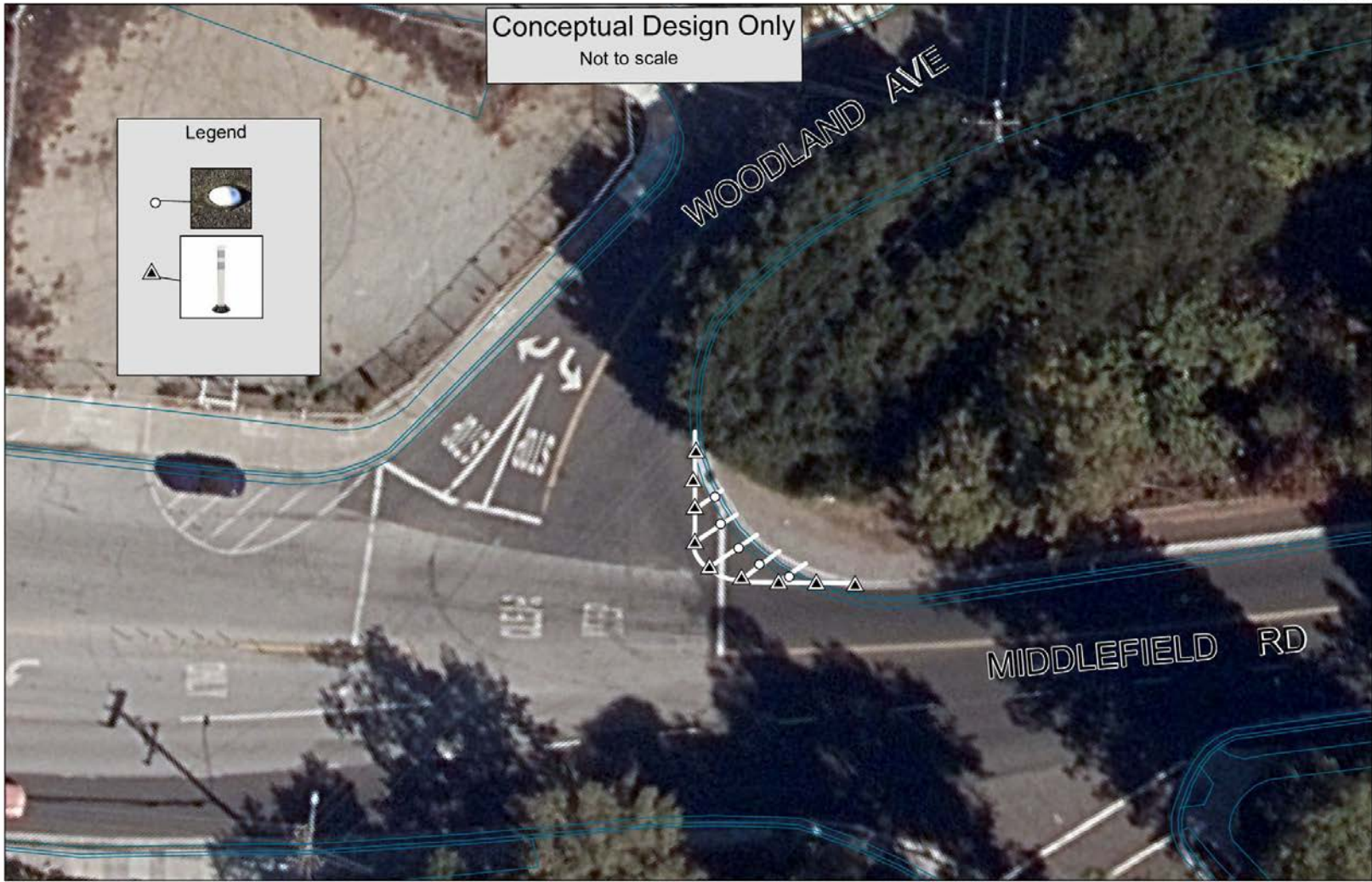

# Bayfront Expressway, Willow Road, and Marsh Road Adaptive Signal Timing Project



Signals Maintained By

- CalTrans
- MP







## NEXT STEPS

- Implementation
- On-going observations
- On-going collection of community observations
- Police presence and enforcement
- Update to City Council in January 2018
- Continue updating community
  - <http://www.menlopark.org/willow101interchange>
  - <http://www.menlopark.org/223/Construction-News-Updates>
  - <http://www.dot.ca.gov/d4/101willowinterchange/>

## CITY COUNCIL ACTION

- Approve resolution to install Short Term Recommendations
  - “No right-turn, 3-7 PM weekdays” at O’Keefe and Chester
  - “No right turn on red, 3-7 PM weekdays” at Durham
  - “Keep clear” on Willow at O’Keefe, Chester, Durham
  - “No left turn, 3-7 PM weekdays” from Woodland to Baywood
  - “No access to Willow” on Laurel at Chester and Menalto at Chester/Green
  - Partial bulb out at Middlefield and Woodland
- Appropriate \$275,000 for adaptive signal project



**THANK YOU**



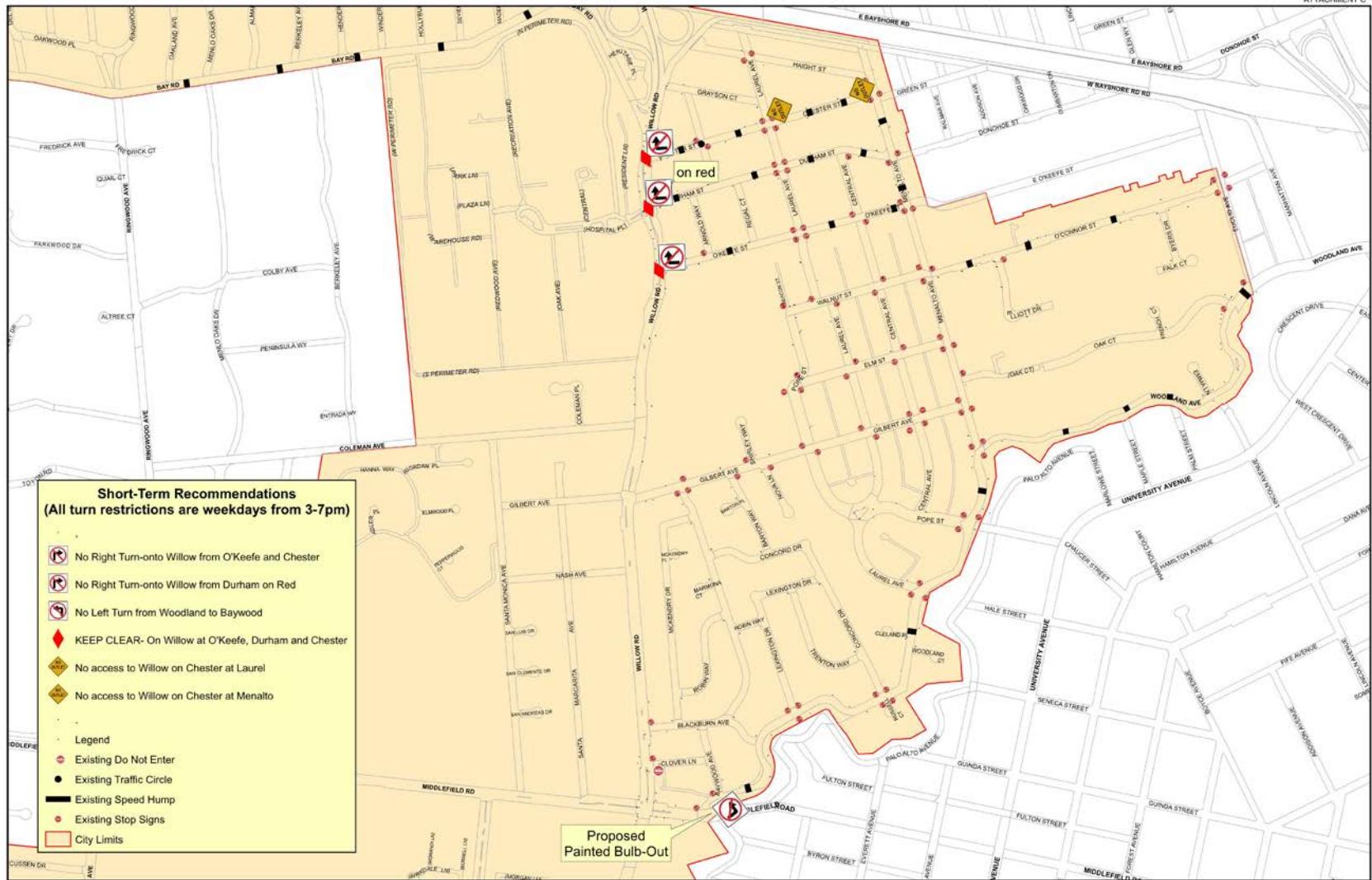





**Short-Term Recommendations**  
 (All turn restrictions are weekdays from 3-7pm)

-  No Right Turn-onto Willow from O'Keefe and Chester
-  No Right Turn-onto Willow from Durham on Red
-  No Left Turn from Woodland to Baywood
-  KEEP CLEAR- On Willow at O'Keefe, Durham and Chester
-  No access to Willow on Chester at Laurel
-  No access to Willow on Chester at Menalta
-  Legend
-  Existing Do Not Enter
-  Existing Traffic Circle
-  Existing Speed Hump
-  Existing Stop Signs
-  City Limits

Proposed  
 Painted Bulb-Out

**Mid-Term Considerations**  
(All turn restrictions are weekdays from 3-7pm)





-  No Right Turn on Red-onto Willow from Gilbert
-  No Left Turn-onto Gilbert from Marmona
-  No Left Turn-onto Blackburn from Woodland
-  No Right Turn-onto Woodland from Pope/Chaucer





Legend

-  Existing Traffic Circle
-  Existing Speed Hump
-  Existing Stop Signs
-  City Limits



**Mid-Term Considerations**  
 (All turn restrictions are weekdays from 3-7pm)



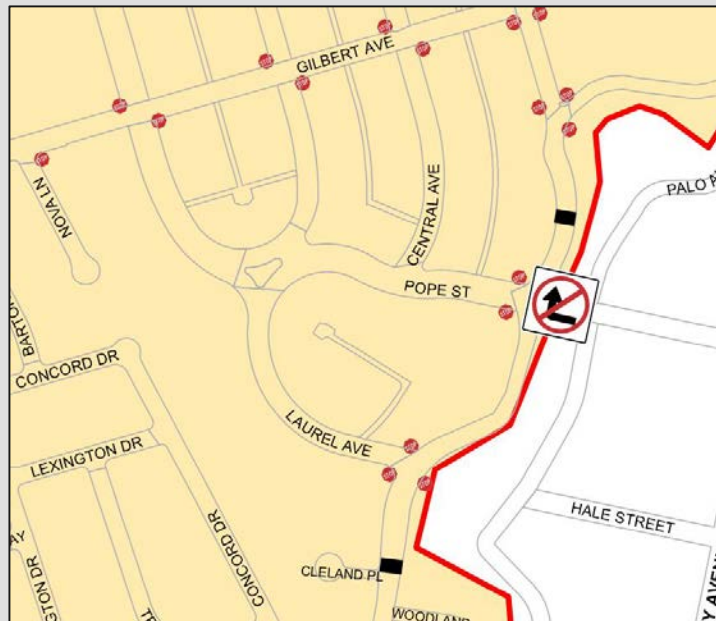

-  No Right Turn on Red-onto Willow from Gilbert
-  No Left Turn-onto Gilbert from Marmona
-  No Left Turn-onto Blackburn from Woodland
-  No Right Turn-onto Woodland from Pope/Chaucer

- Legend
-  Existing Traffic Circle
  -  Existing Speed Hump
  -  Existing Stop Signs
  -  City Limits





**Mid-Term Considerations**  
(All turn restrictions are weekdays from 3-7pm)



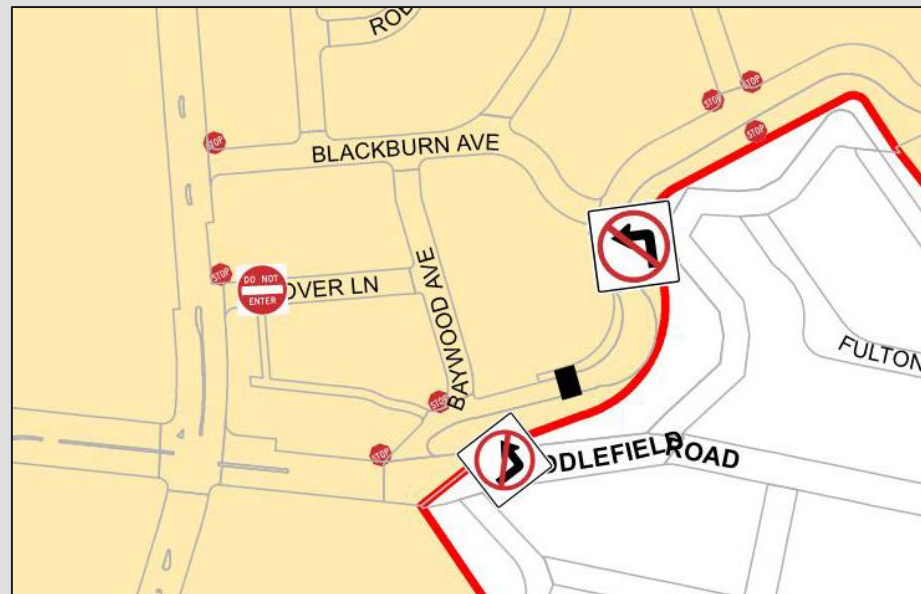

-  No Right Turn on Red-onto Willow from Gilbert
-  No Left Turn-onto Gilbert from Marmona
-  No Left Turn-onto Blackburn from Woodland
-  No Right Turn-onto Woodland from Pope/Chaucer

Legend





-  Existing Traffic Circle
-  Existing Speed Hump
-  Existing Stop Signs
-  City Limits



**Mid-Term Considerations**  
(All turn restrictions are weekdays from 3-7pm)

-  No Right Turn on Red-onto Willow from Gilbert
-  No Left Turn-onto Gilbert from Marmona
-  No Left Turn-onto Blackburn from Woodland
-  No Right Turn-onto Woodland from Pope/Chaucer



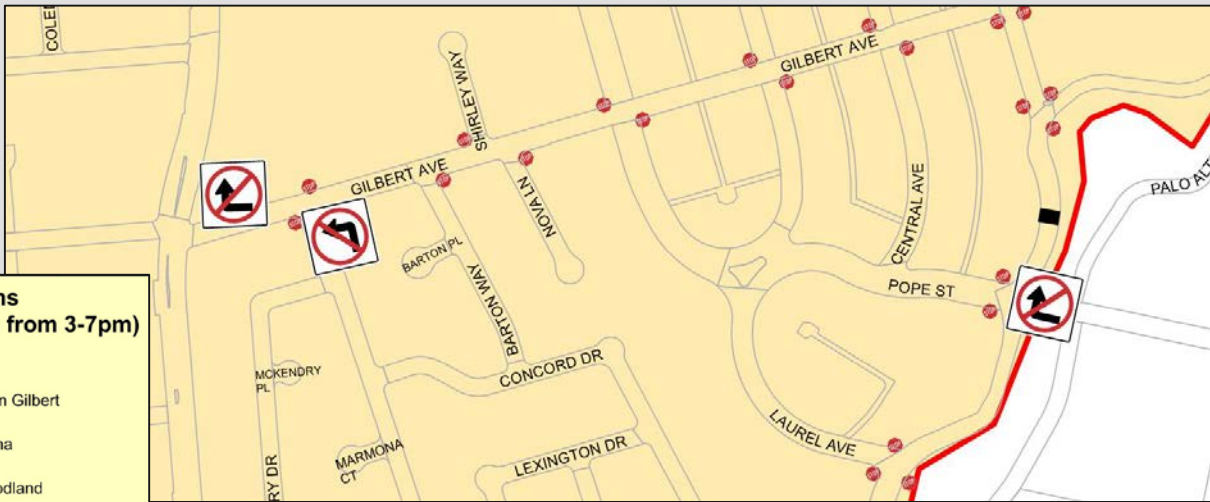

Legend

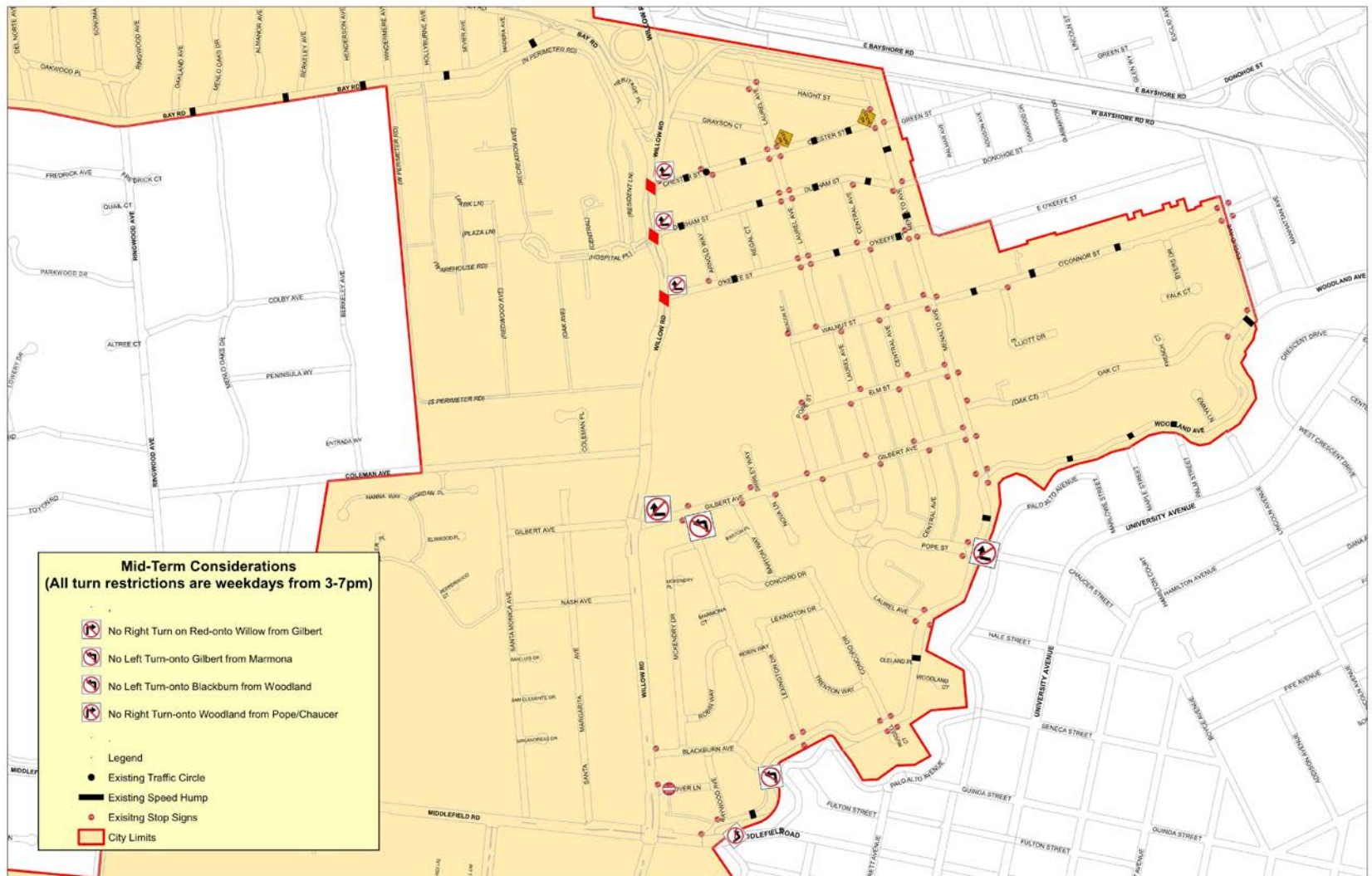
-  Existing Traffic Circle
-  Existing Speed Hump
-  Existing Stop Signs
-  City Limits







**Mid-Term Considerations**  
**(All turn restrictions are weekdays from 3-7pm)**

-  No Right Turn on Red-onto Willow from Gilbert
-  No Left Turn-onto Gilbert from Marmona
-  No Left Turn-onto Blackburn from Woodland
-  No Right Turn-onto Woodland from Pope/Chaucer

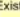
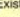
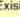
Legend

-  Existing Traffic Circle
-  Existing Speed Hump
-  Existing Stop Signs
-  City Limits





# 2040 DESIGN YEAR OPERATIONAL ANALYSIS FOR AM PEAK

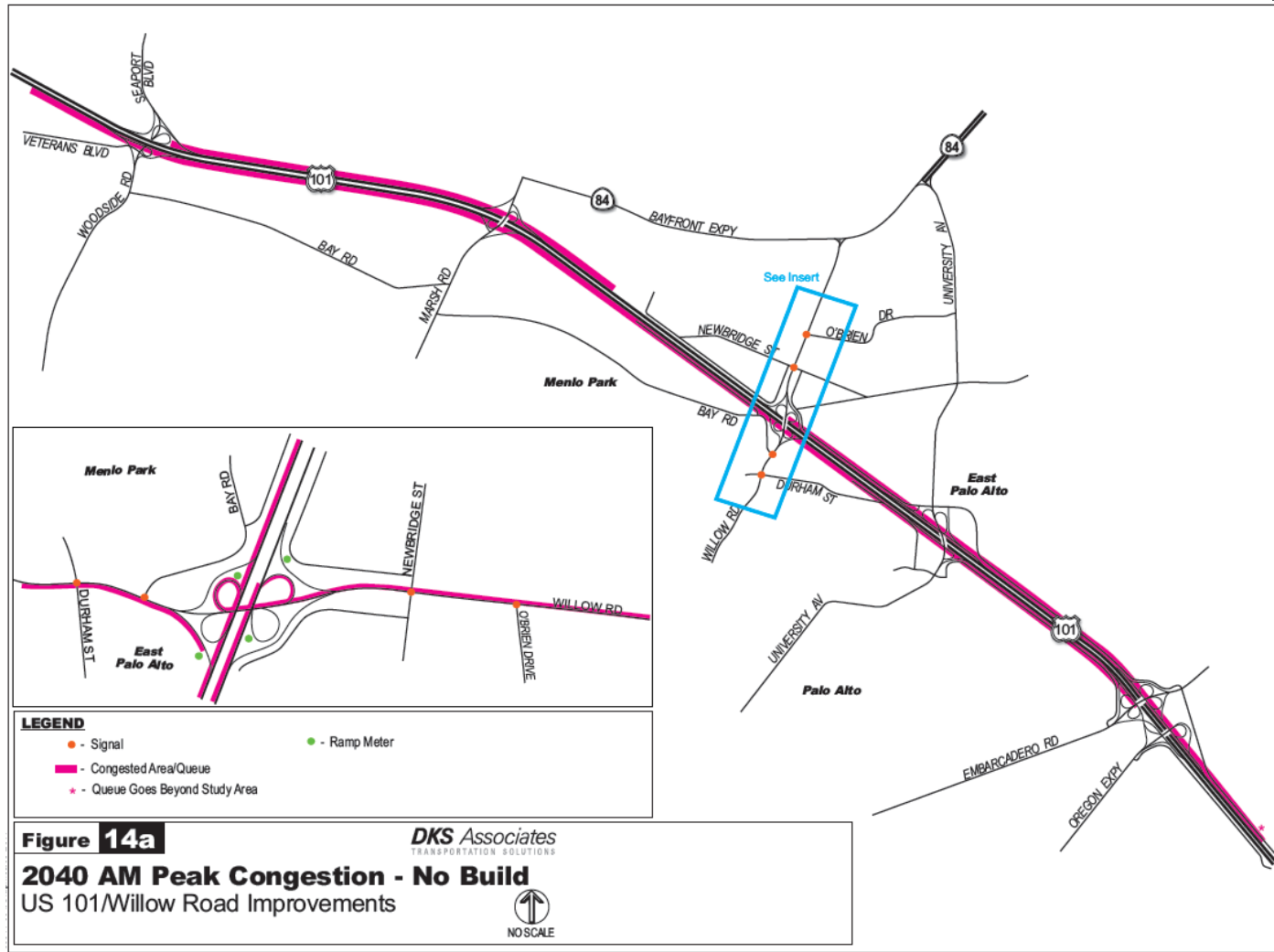

DKS Associates  
TRANSPORTATION SOLUTIONS



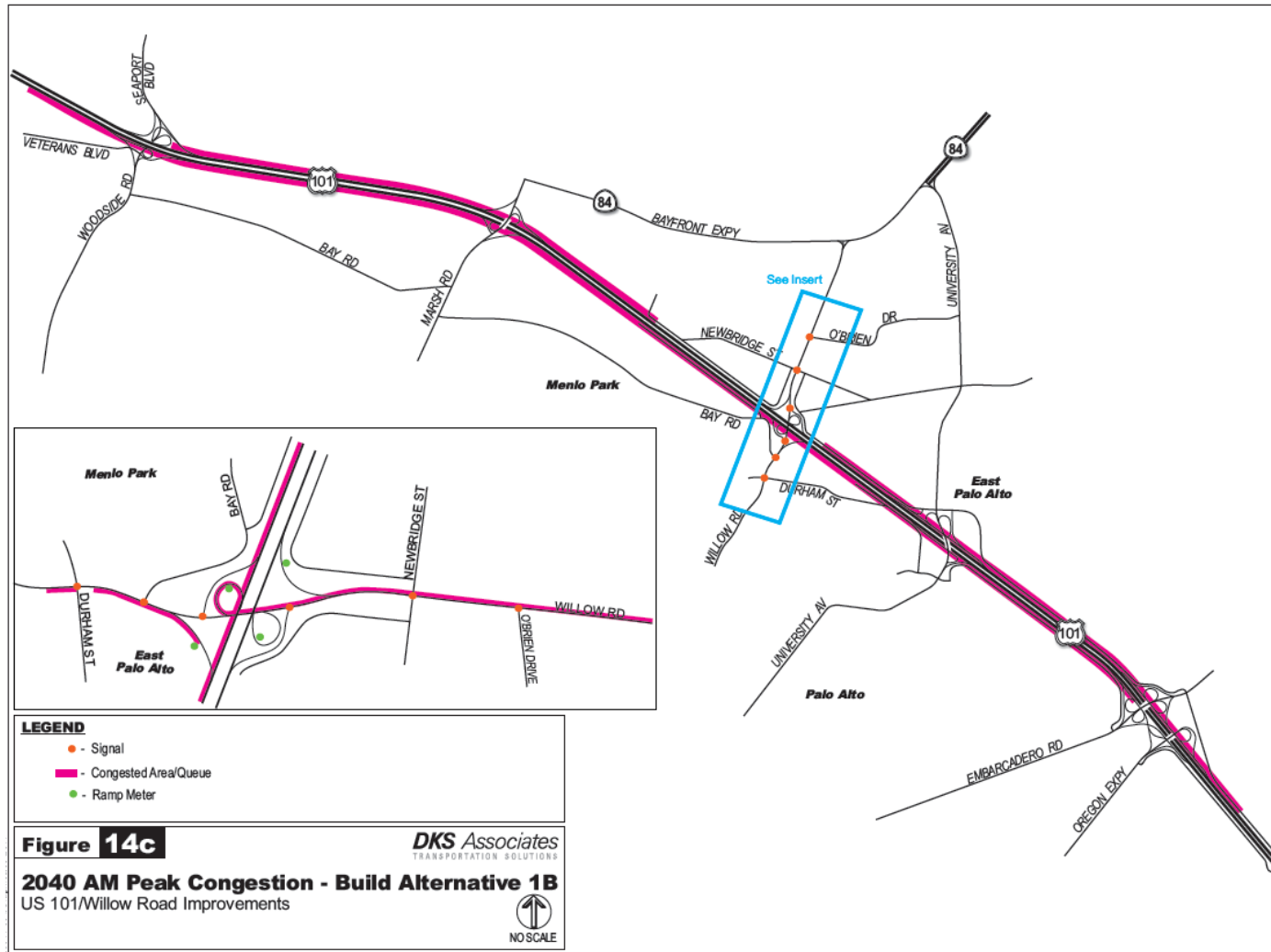

**LEGEND**

- - Signal
- Congested Area/Queue
- - Ramp Meter

**Figure 14c**

**2040 AM Peak Congestion - Build Alternative 1B**  
US 101/Willow Road Improvements

*DKS Associates*  
TRANSPORTATION SOLUTIONS



NO SCALE



# 2040 DESIGN YEAR OPERATIONAL ANALYSIS FOR PM PEAK



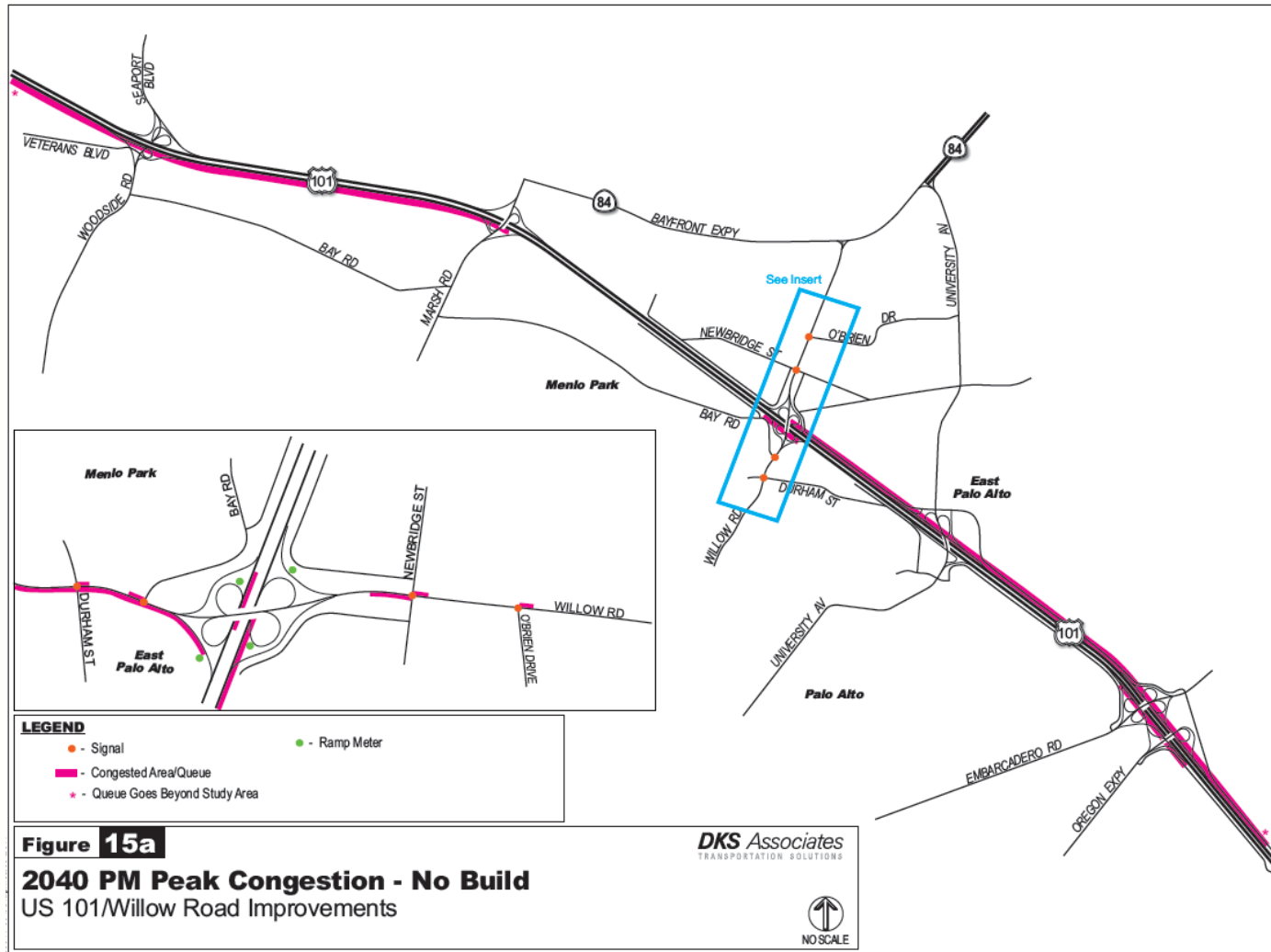

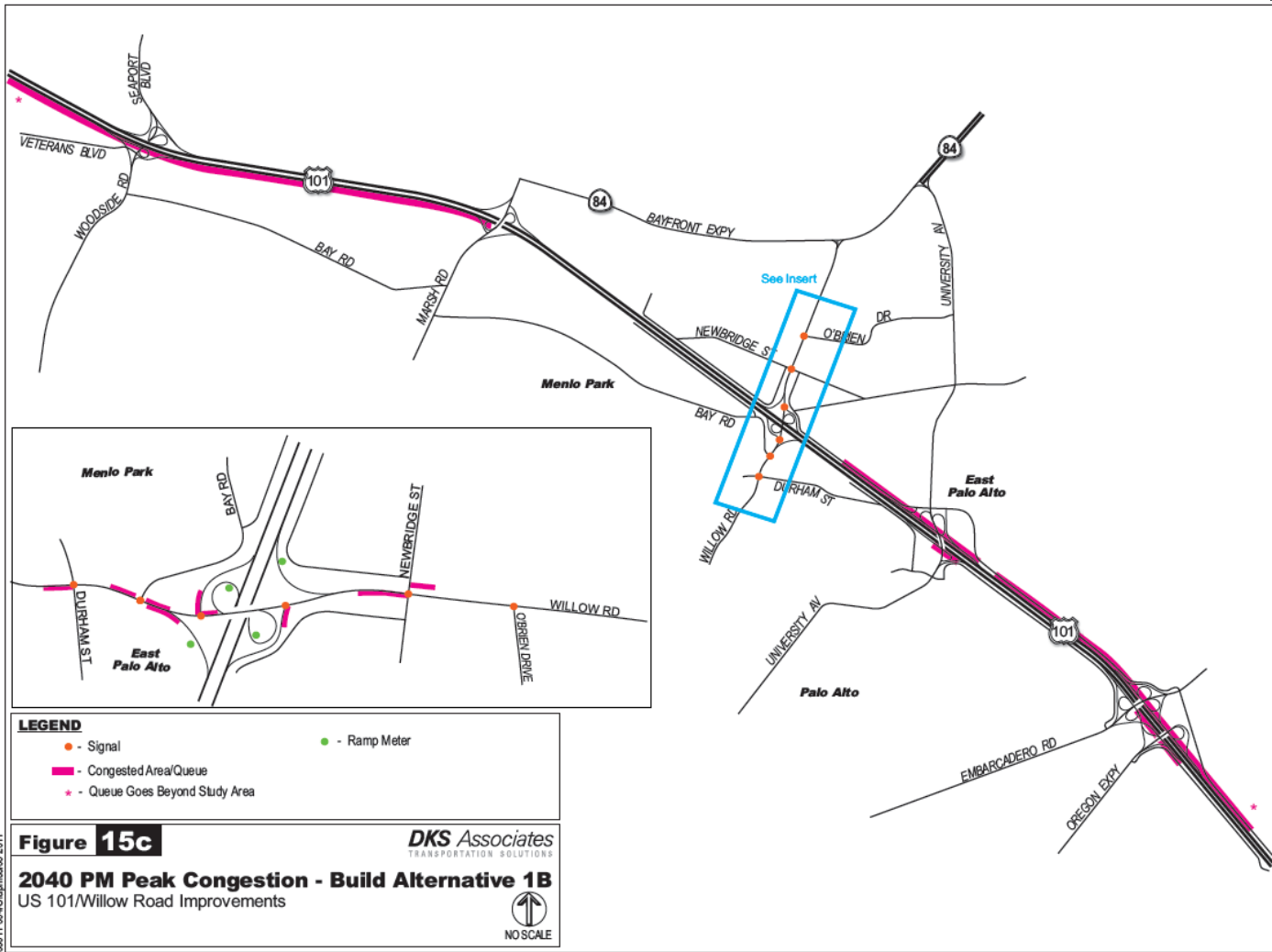



# 2040 DESIGN YEAR OPERATIONAL ANALYSIS FOR AM PEAK

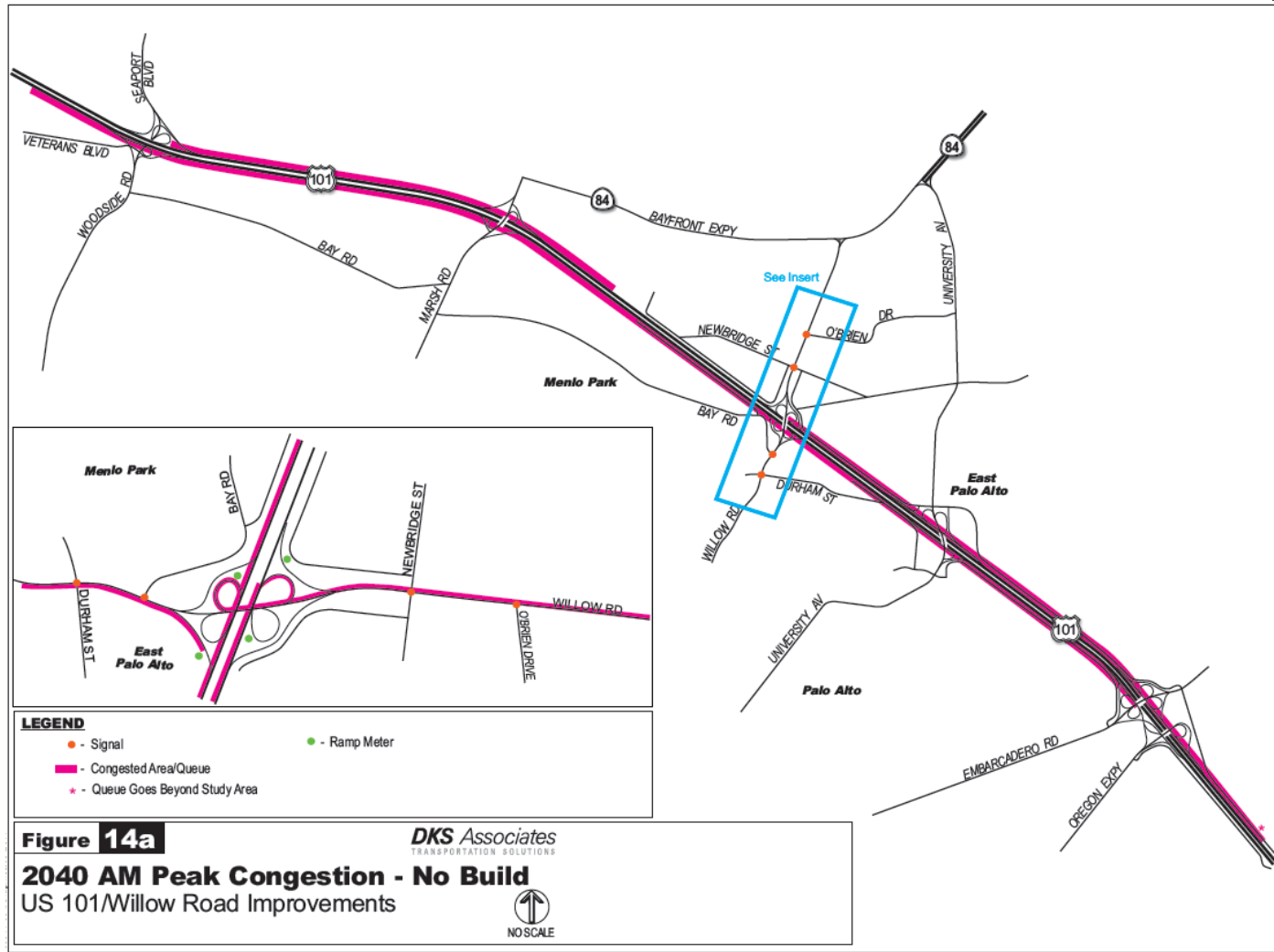

**Figure 14a**

**2040 AM Peak Congestion - No Build**  
**US 101/Willow Road Improvements**

*DKS Associates*  
 TRANSPORTATION SOLUTIONS





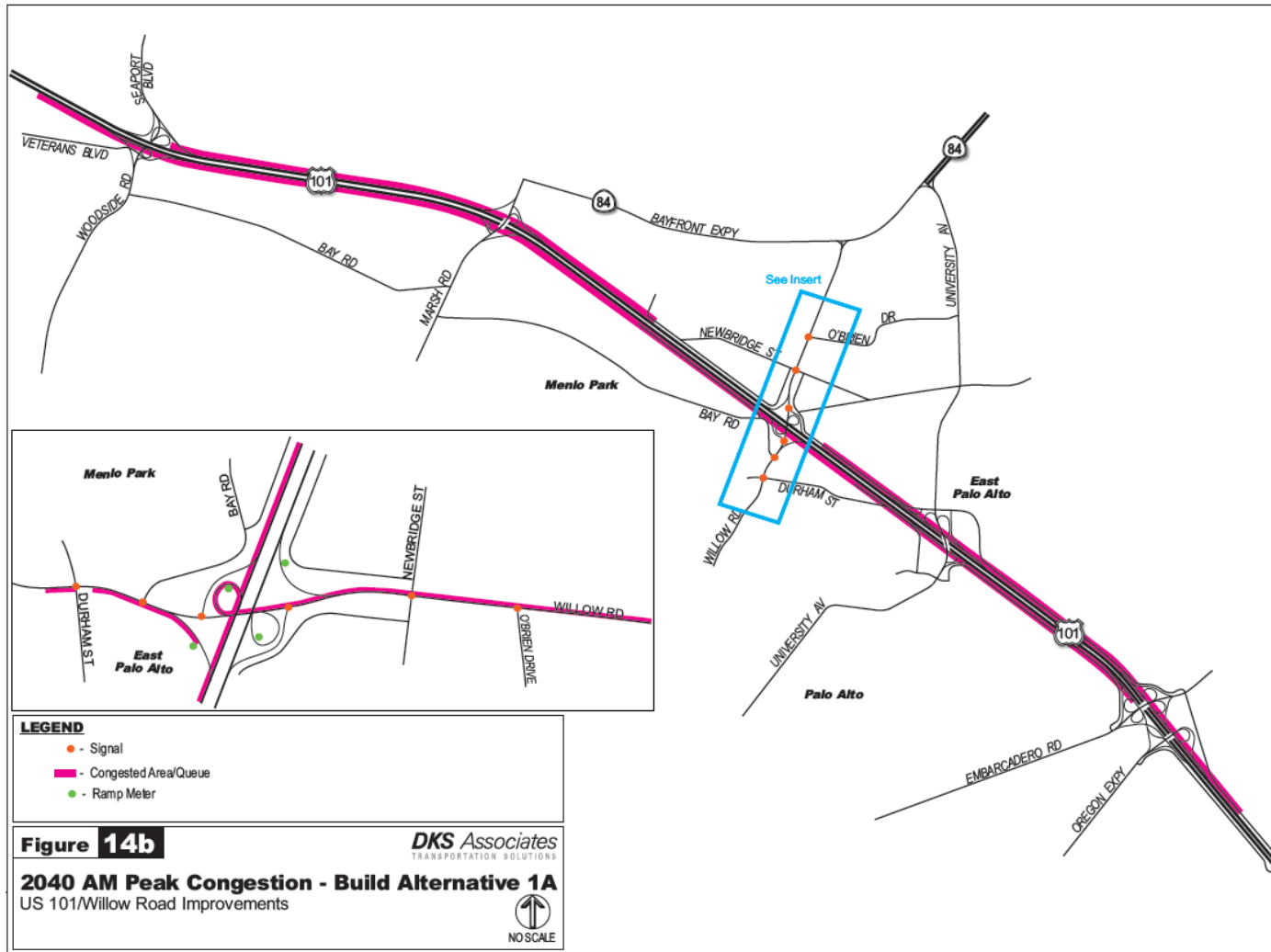

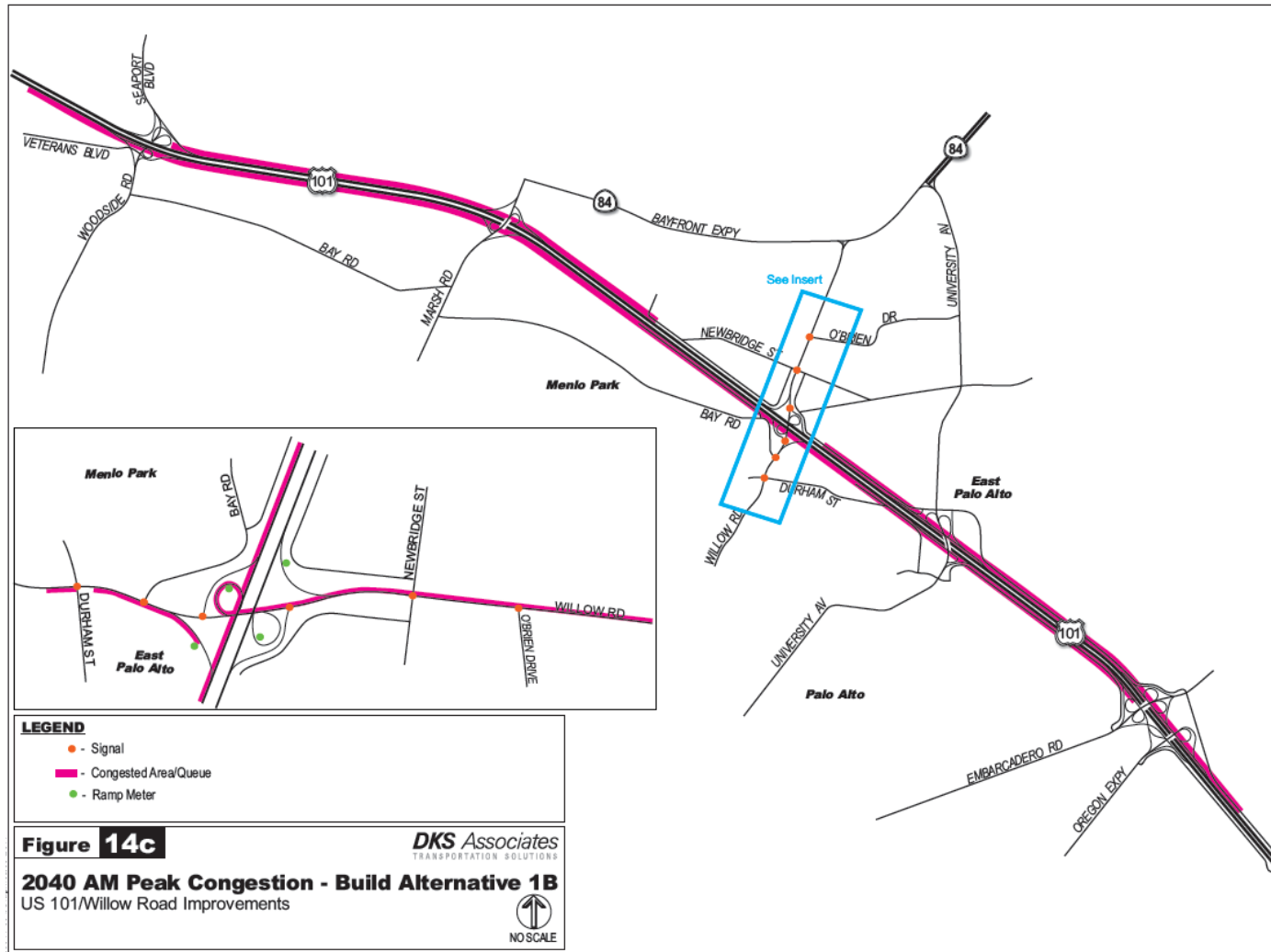

**LEGEND**

- - Signal
- - Congested Area/Queue
- - Ramp Meter

**Figure 14c**

**2040 AM Peak Congestion - Build Alternative 1B**  
US 101/Willow Road Improvements

*DKS Associates*  
TRANSPORTATION SOLUTIONS



NO SCALE

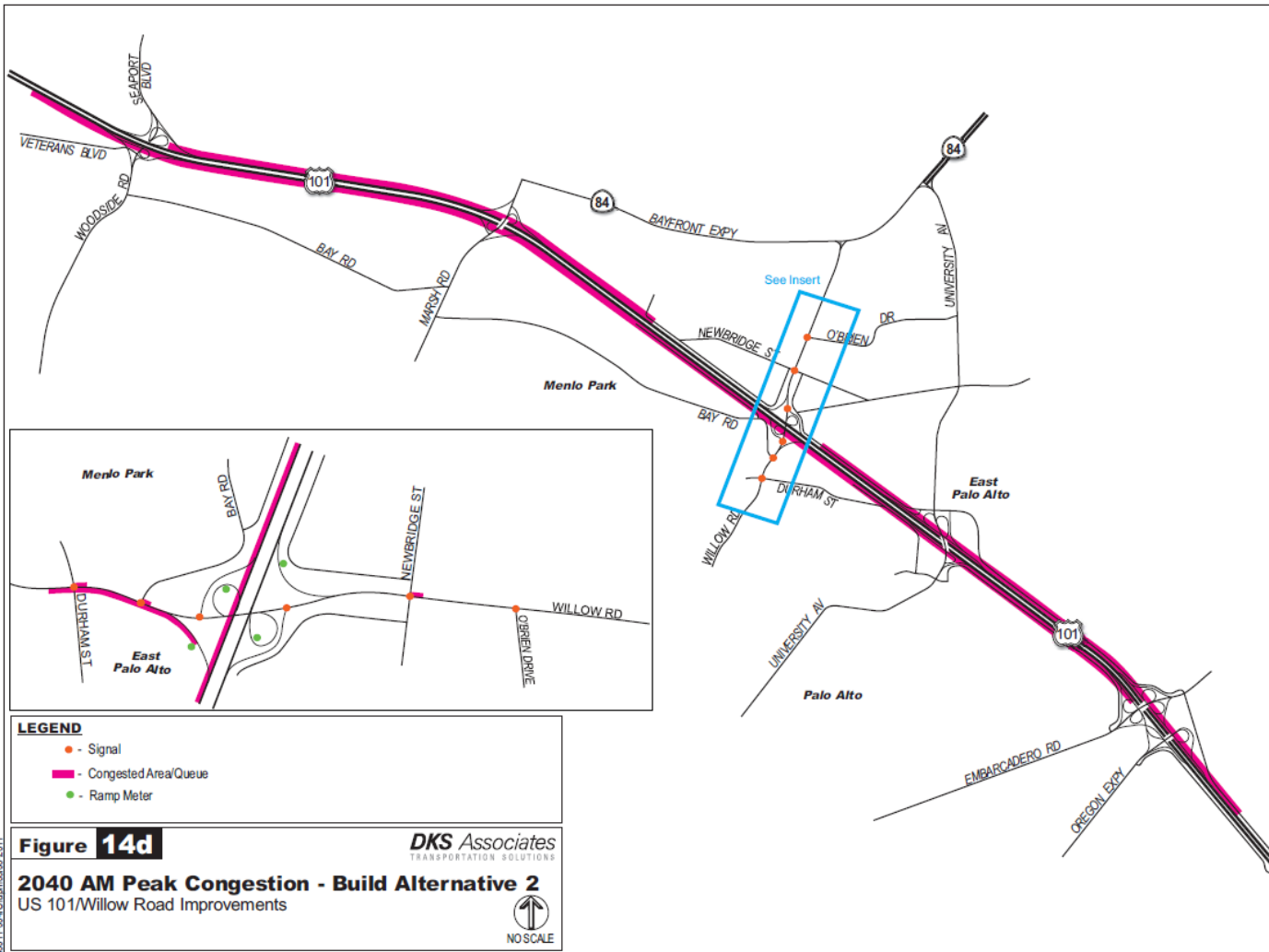

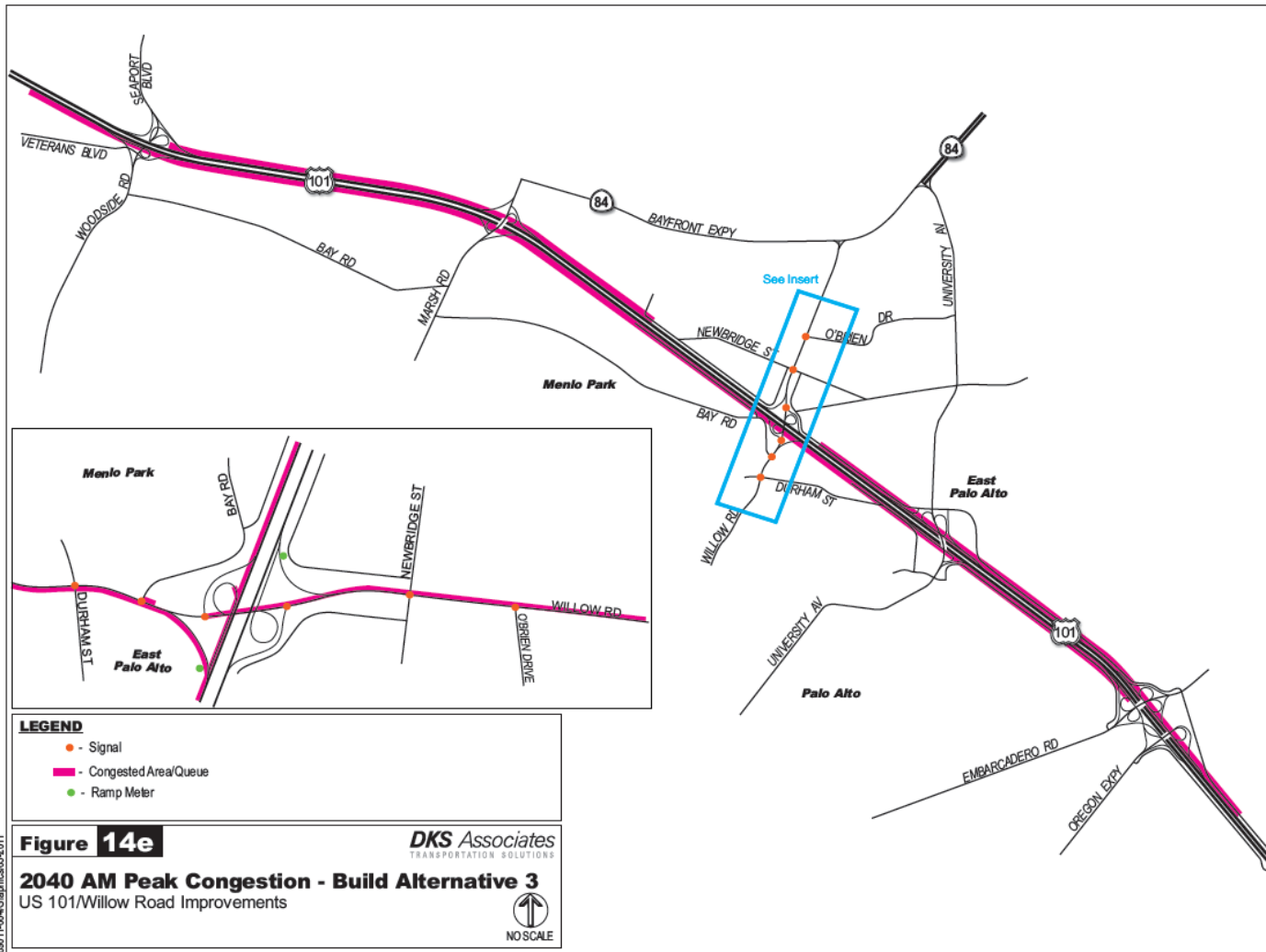

- LEGEND**
- - Signal
  - - Congested Area/Queue
  - - Ramp Meter

**Figure 14e**

**2040 AM Peak Congestion - Build Alternative 3**  
US 101/Willow Road Improvements

*DKS Associates*  
TRANSPORTATION SOLUTIONS

NO SCALE

10/11/2014 10:00 AM



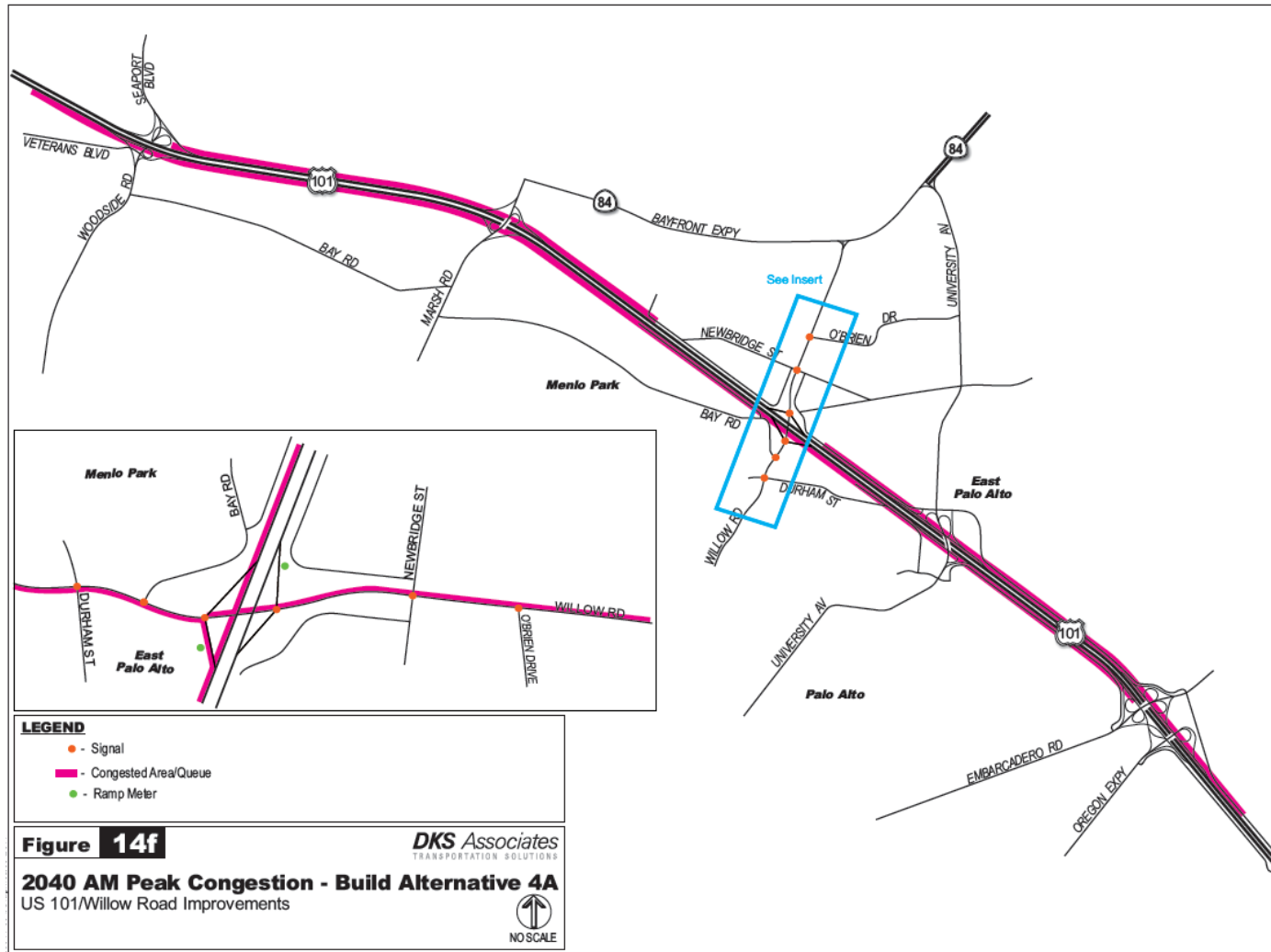

**LEGEND**

- - Signal
- - Congested Area/Queue
- - Ramp Meter

**Figure 14f**

**2040 AM Peak Congestion - Build Alternative 4A**  
US 101/Willow Road Improvements

*DKS Associates*  
TRANSPORTATION SOLUTIONS



NO SCALE

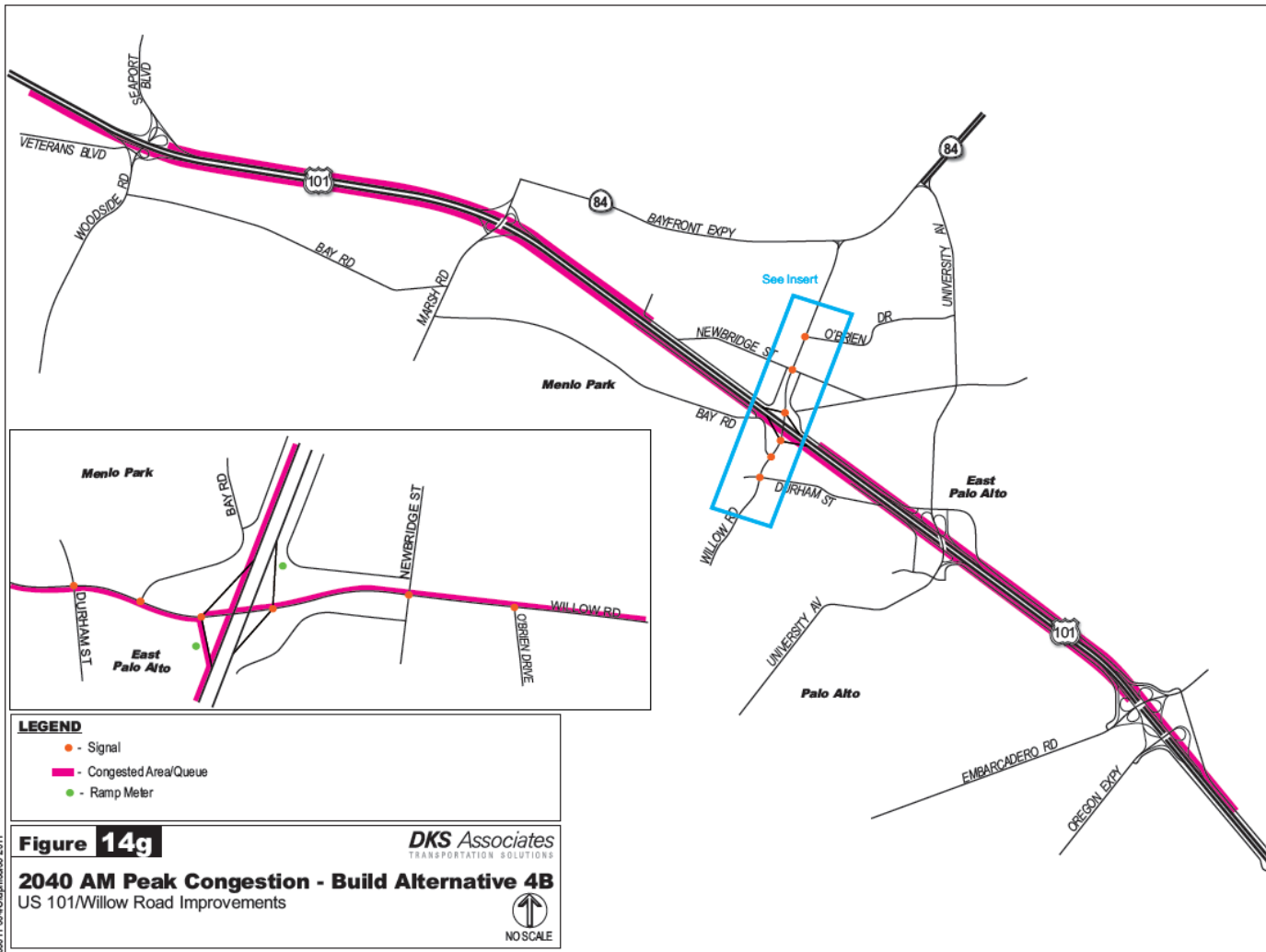

**Figure 14g**

**2040 AM Peak Congestion - Build Alternative 4B**  
US 101/Willow Road Improvements

*DKS Associates*  
TRANSPORTATION SOLUTIONS





# 2040 DESIGN YEAR OPERATIONAL ANALYSIS FOR PM PEAK

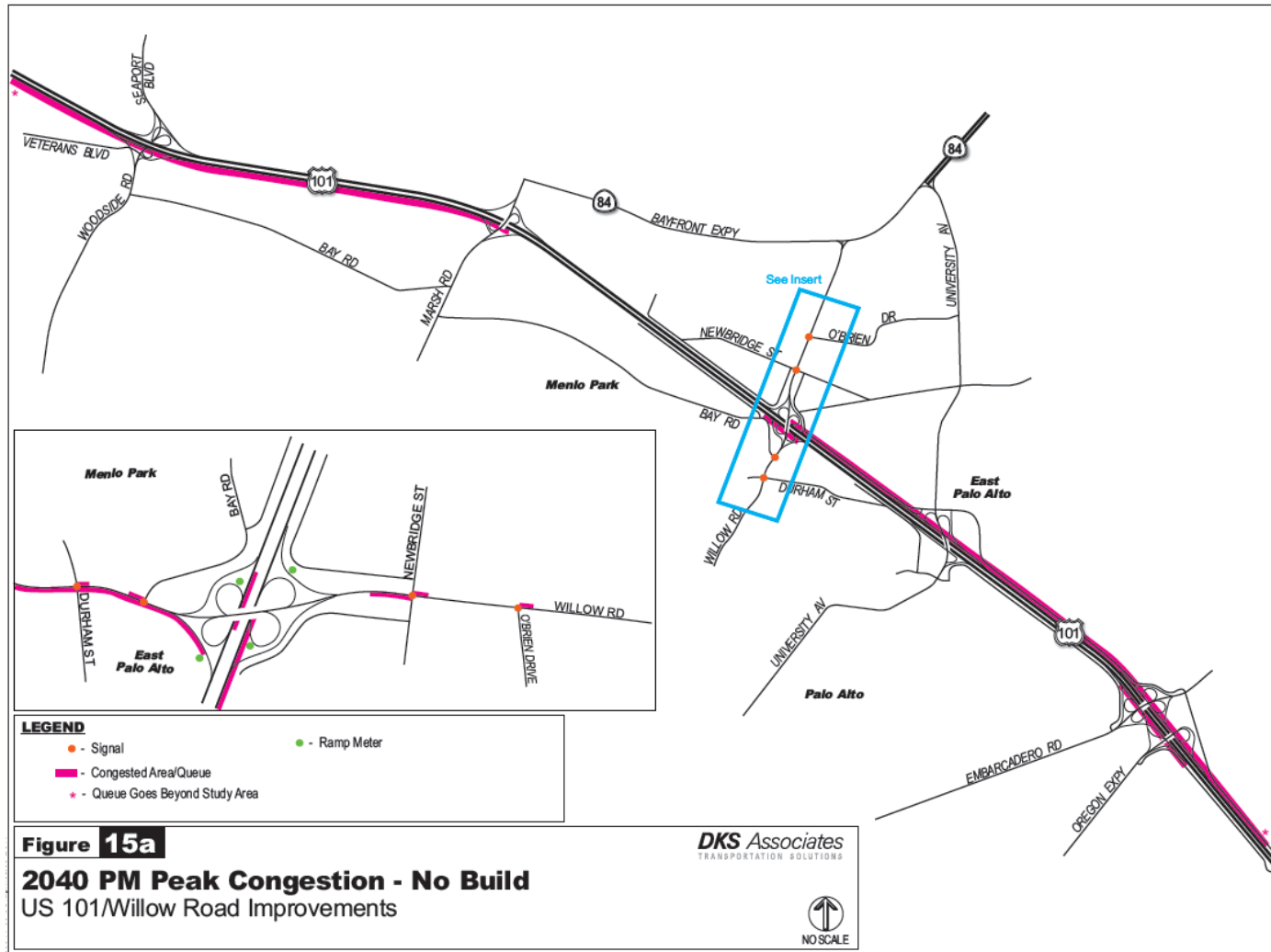



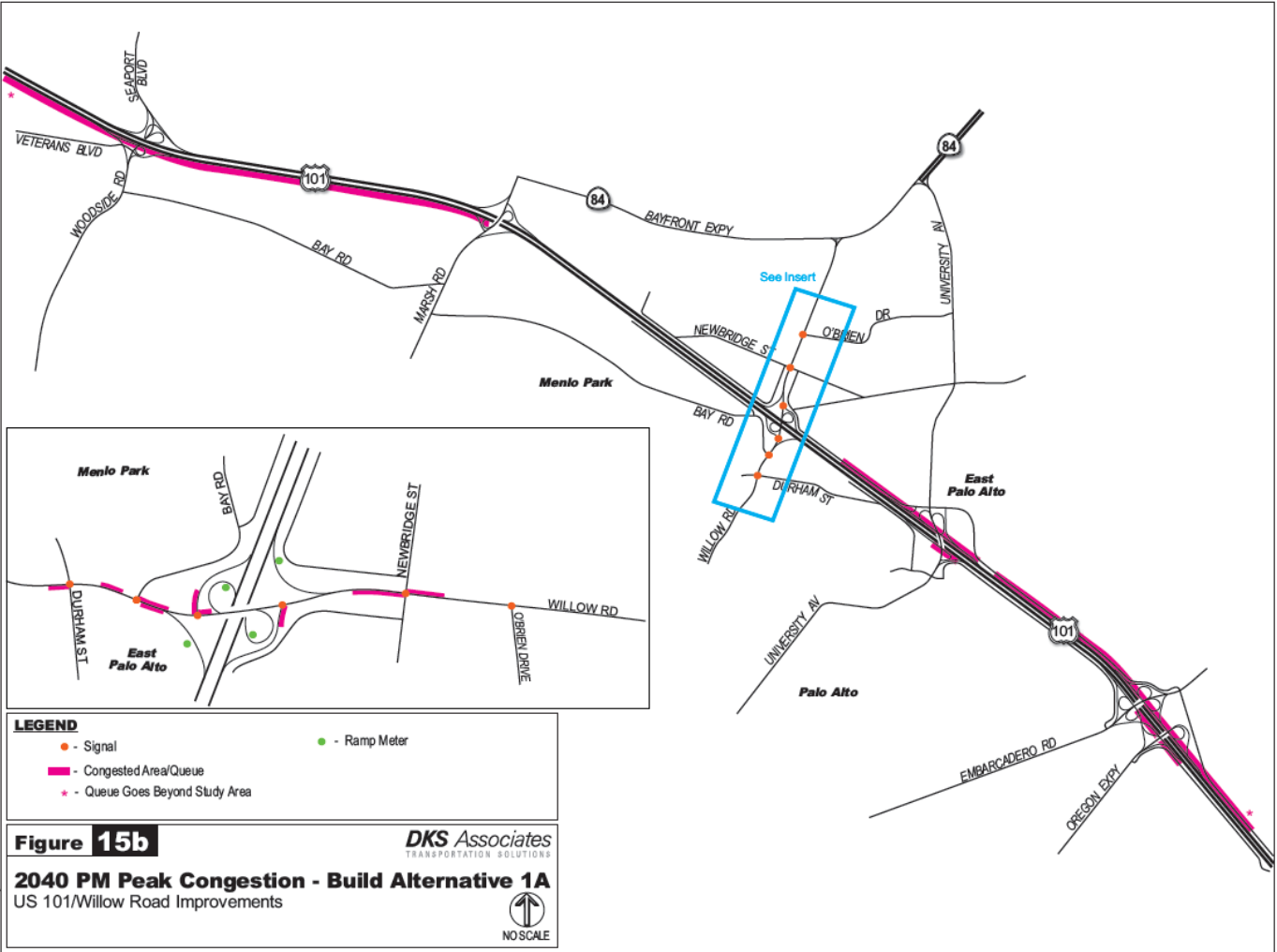
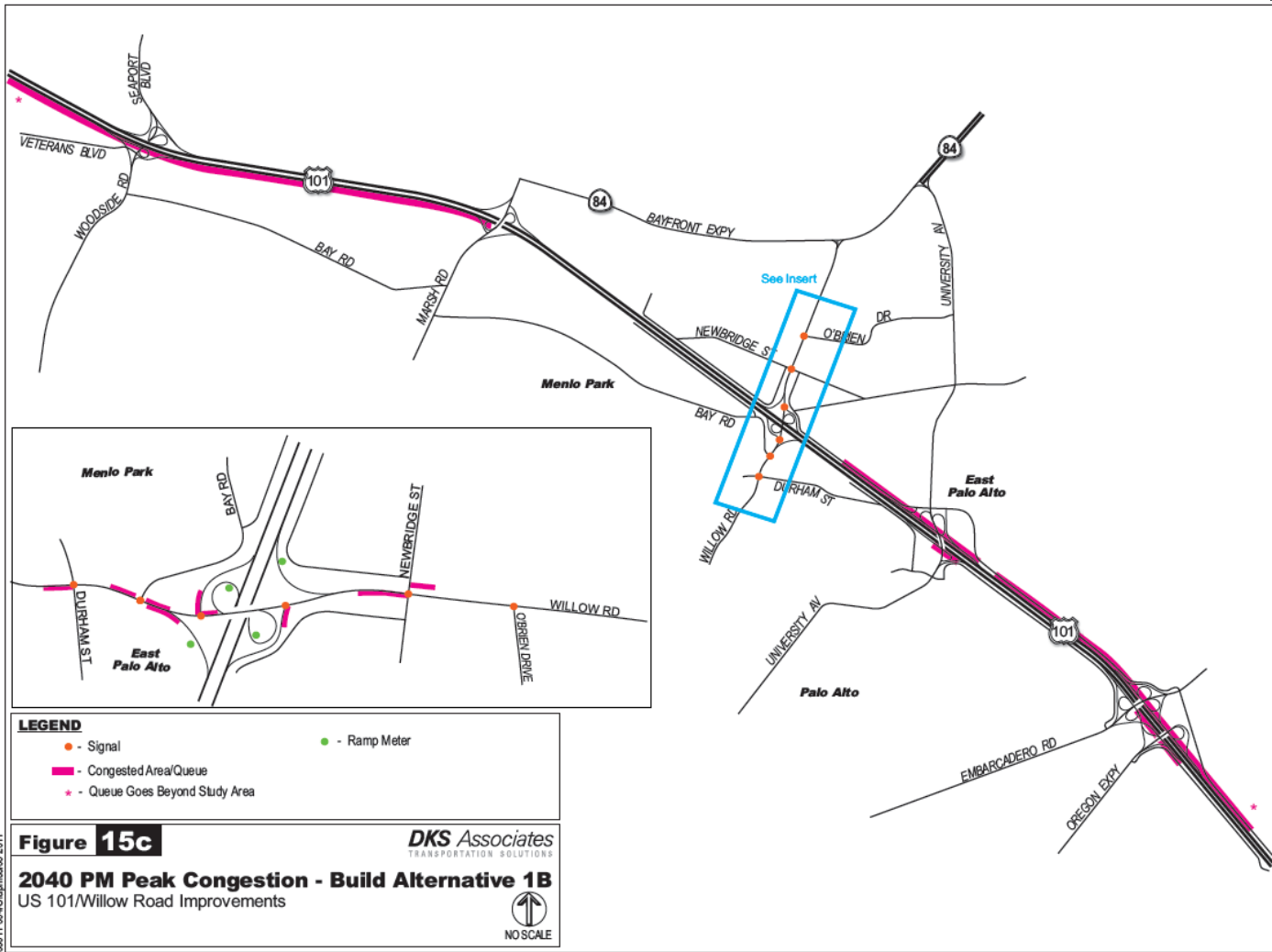

**Figure 15b**

**2040 PM Peak Congestion - Build Alternative 1A**  
US 101/Willow Road Improvements

*DKS Associates*  
TRANSPORTATION SOLUTIONS







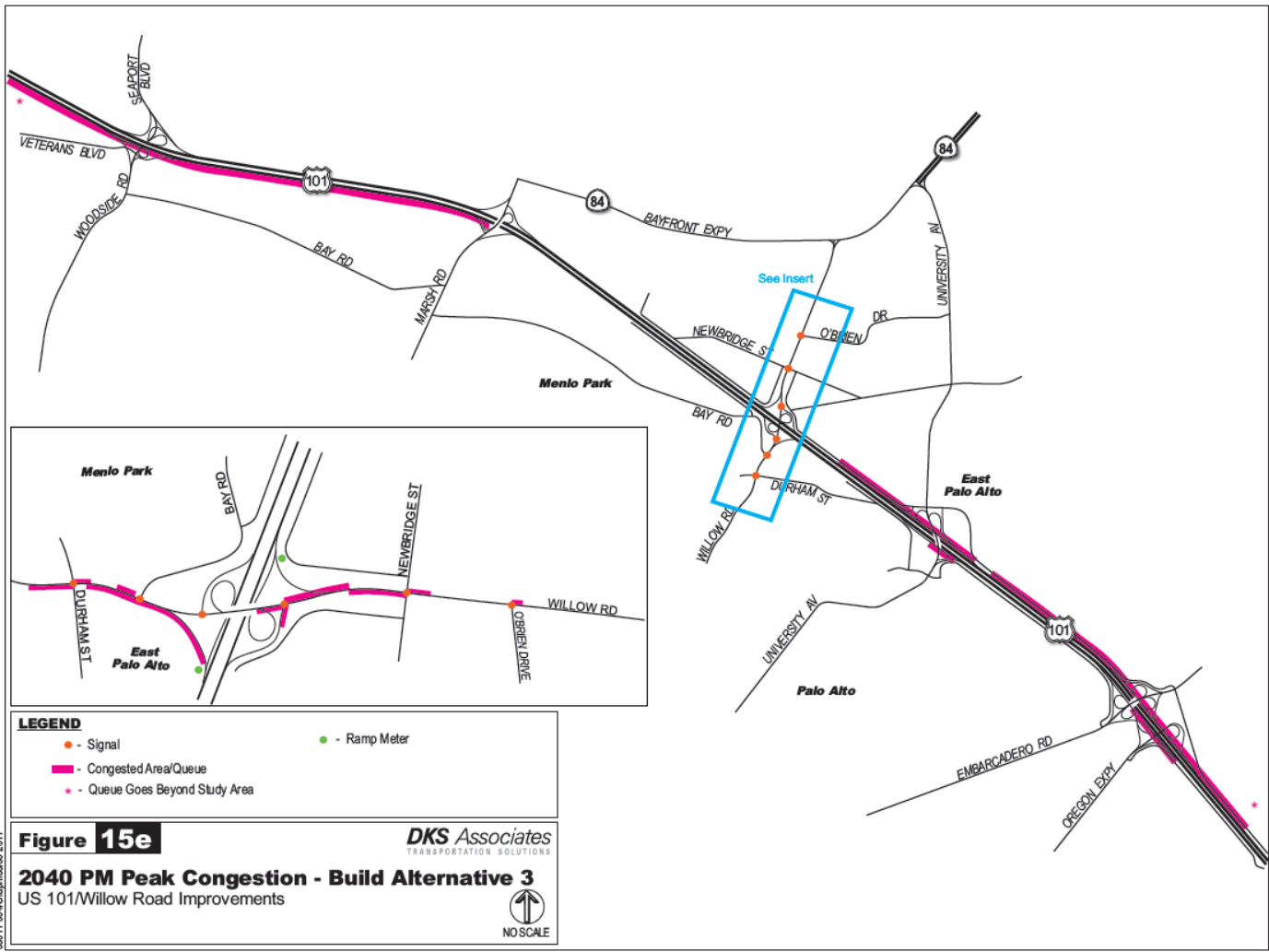

*DKS Associates*  
 TRANSPORTATION SOLUTIONS





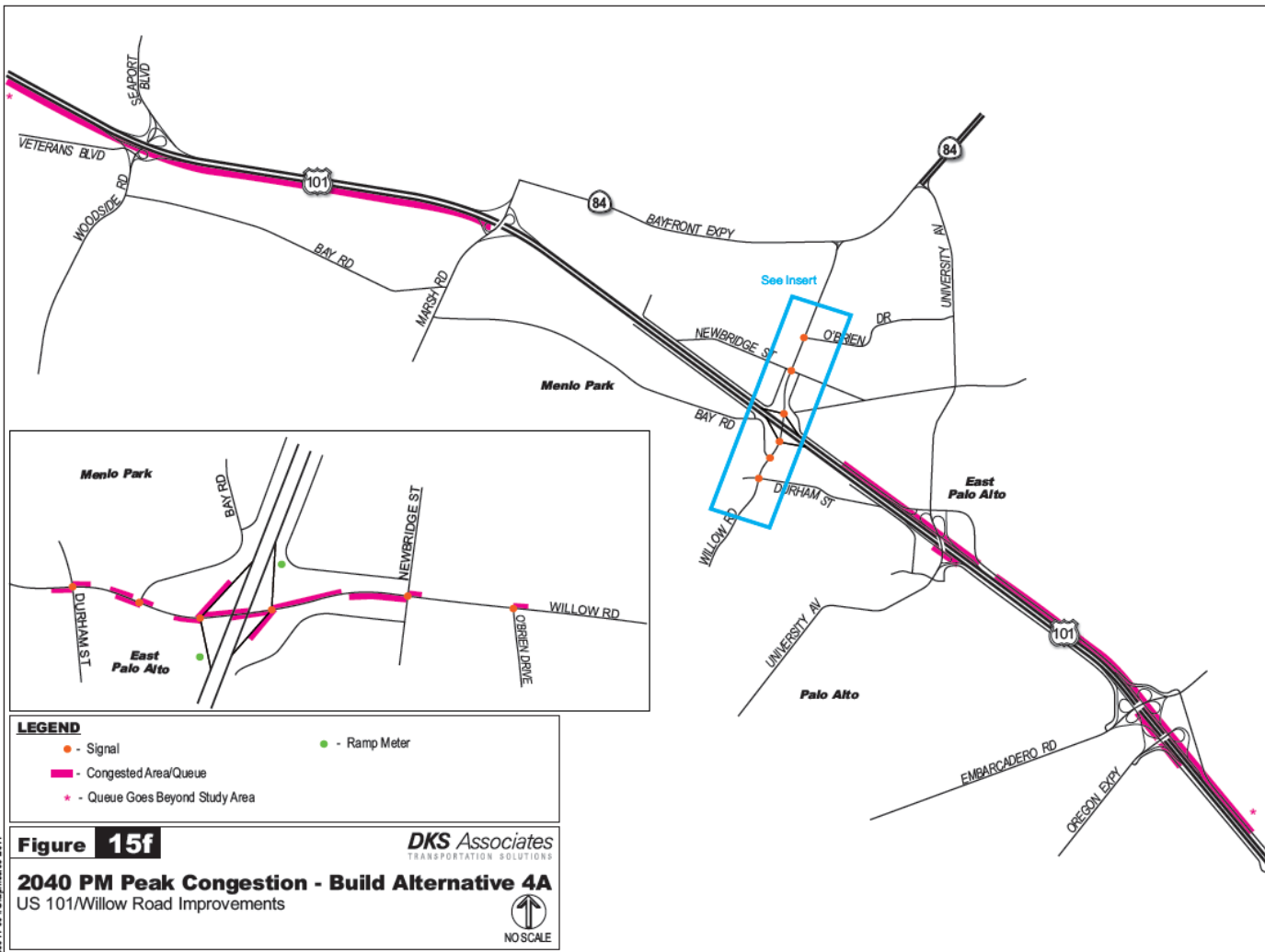

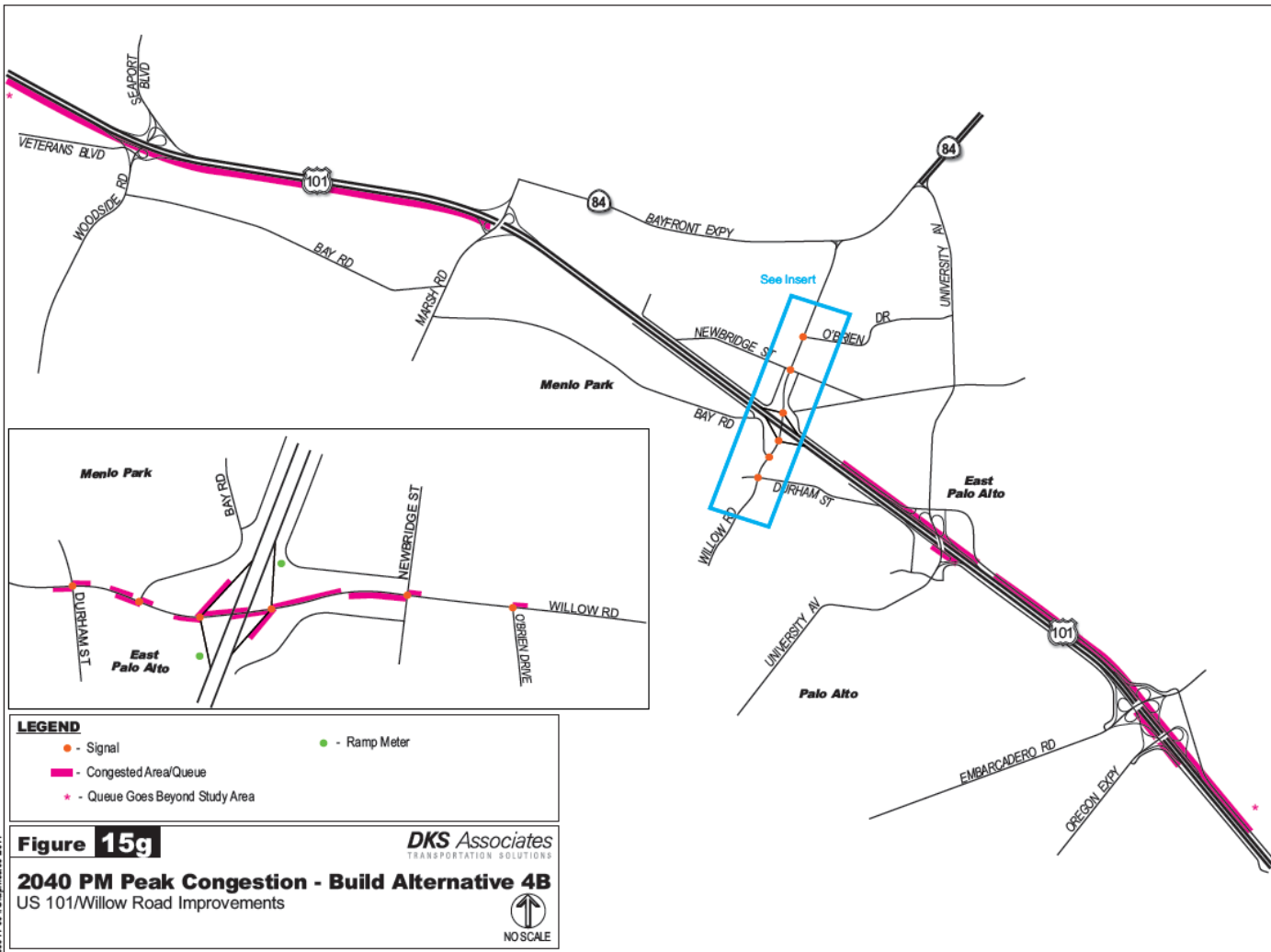

# AGENDA

- Project Background
- Current Conditions
- Community Input
- Staff Recommendations
- Council Action



## SUMMARY OF RECOMMENDATIONS

- Approve installation of Short Term Recommendations
- Appropriate funds for adaptive signal project
- No studies performed
- On-going observations
- On-going collection of community observations
- Police presence and enforcement



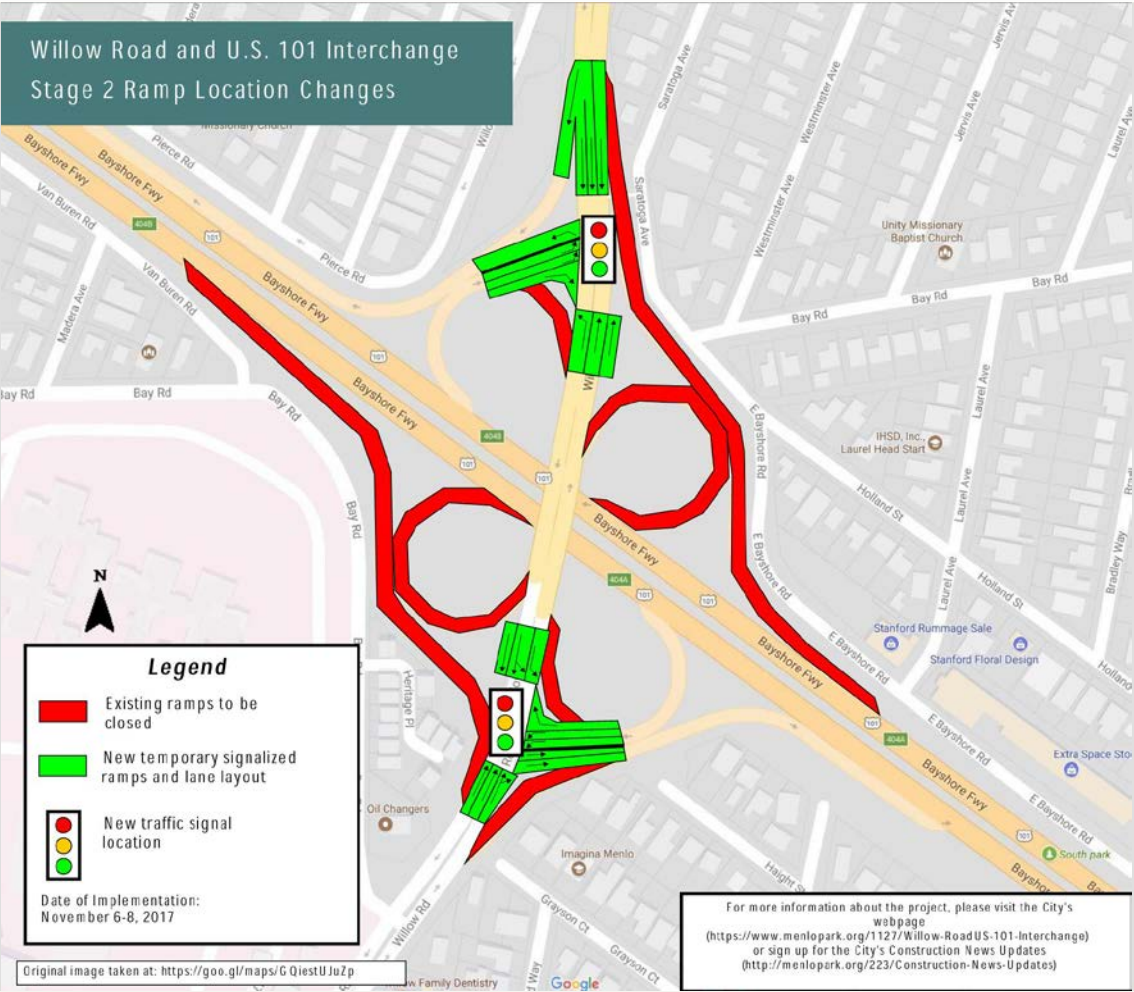

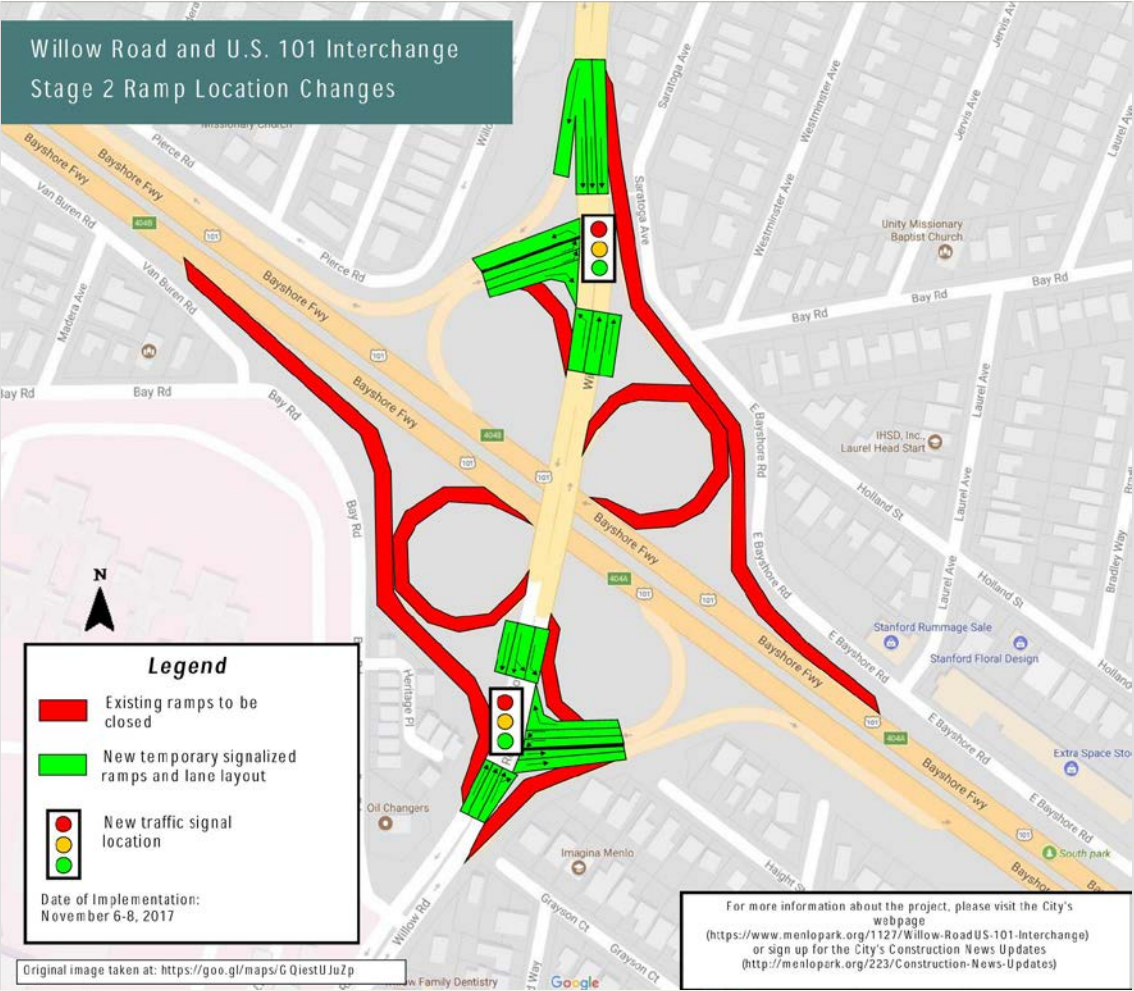



# CURRENT CONDITIONS



## CALTRANS ACTIVITIES

- Signal turn-on activities
- Signal malfunctions and corrections
- Actions in process
  - Additional interchange signs
  - Refresh striping
  - Signal timing adjustments
  - Continued monitoring





***GET US MOVING* SAN MATEO COUNTY  
TRANSPORTATION EXPENDITURE PLAN**

ANNIERGA FAMILY  
GYMNASIUM



## DRAFT PROJECT LIST RECOMMENDATIONS

- Re-activate Dumbarton rail
- Roadway and railroad grade separations
- Railroad crossing improvements
- Bayfront Expressway express lanes
- Bicycle/pedestrian multi-use trail
- El Camion Real pedestrian crossing and streetscape
- Build out city bicycle network
- Enhance Dumbarton Express bus service
- Pedestrian crossing improvements



**THANK YOU**





# NEWSRACKS

Meghan Revolinsky, Management Analyst II

Jim Cogan, Housing & Economic Development Manager

# THE PROBLEM

- Dilapidation
- Uncontrolled
- Deserted
- Trash receptacles





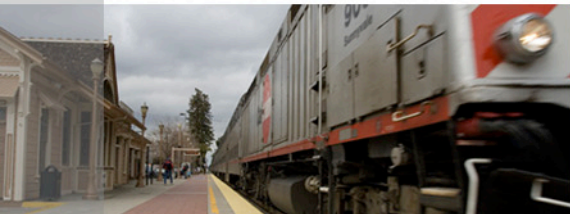

# HISTORY OF NEWSRACKS IN THE CITY



- 1980's
  - Similar problems
  - Beautification Commission and publishers collaborated
  - Installed the “Green Boxes”
  - Golden Acorn Award to Mrs. Irene Giovacchini
  - No ordinance passed
  - No usage agreement

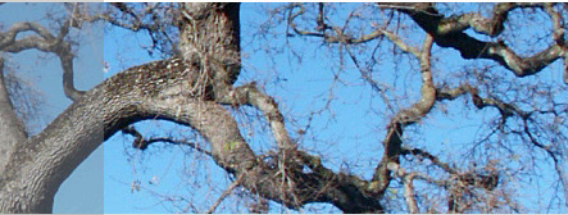

# TIMELINE



- 2016
  - Surge of complaints
  - Inventoried downtown newsracks
  - No abatement without an ordinance
- 2017
  - Additional complaints
  - March: Inventoried, photographed, and gathered more information on newsracks
  - August: Informational staff report & commitment to conduct community outreach
  - October: Community meeting
  - November: Informational item submitted about the community meeting

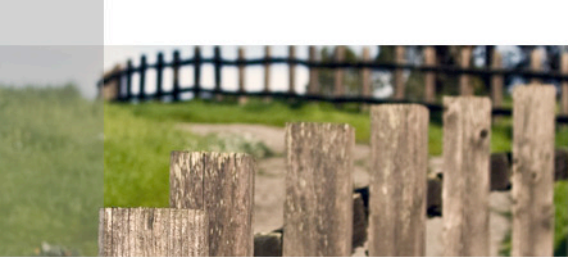

# COMMUNITY MEETING



- Wednesday, October 25, 2017
- Extensive Outreach
- Responses received via emails and phone calls
  - Desire for improvement
  - Provide valued access to publications
  - Publishers request reasonable permit fees and freedom in distribution locations
- Responses from the meeting
  - Minimal restrictions on distribution locations and frequency
  - Question the need for an ordinance
  - Give publishers six months to address the complaints

# OPTIONS FOR NEXT STEPS

## 1. Maintain status quo

- Allow the publishers to self-police
- Temporary reduction of branded modular racks
- No improvement to the green pedestal racks
- Does not address any future complaints

## 2. Direct staff to draft an ordinance

- Allow the City to legally remove abandoned or not maintained newsracks
- Create standards for placement and maintenance
- Options for additional degrees of regulations
- Council direction on policy questions

## 3. Create a Stakeholder Group

- Develop policy recommendations for Council approval





# POLICY QUESTIONS



1. Does the City Council want to standardize the newsracks?
  - a. Style (pedestal or modular)
  - b. Size
  - c. Color
  - d. Manufacturer and/or model
  
2. Does the City Council want to regulate newsracks locations within the City?
  
3. Does the City Council want to restrict the number of newsracks allowed?



# OPTIONS

1. Maintain status quo
2. Direct staff to draft an ordinance
3. Create a Stakeholder Group



**WEST BAY**  
SANITARY DISTRICT



# West Bay Sanitary District

## Recycled Water Project – Sharon Heights

### Status Update for the City of Menlo Park City Council

December 5, 2017



# Presentation Overview

## 1 Project Status



West Bay Sanitary District  
**Recycled Water Facilities Plan**

## 2 Project Layout



## 3 Pipe Alignment





# Project Status and Schedule

- State funding in place – January 2018
- Award a Design/Build Team – January 2018
- Design – January 2018 through June 2018
- Begin construction – April 2018 (dependent on status of permits)
- Sand Hill pipeline construction - 4 months
- Project completion – June 2019

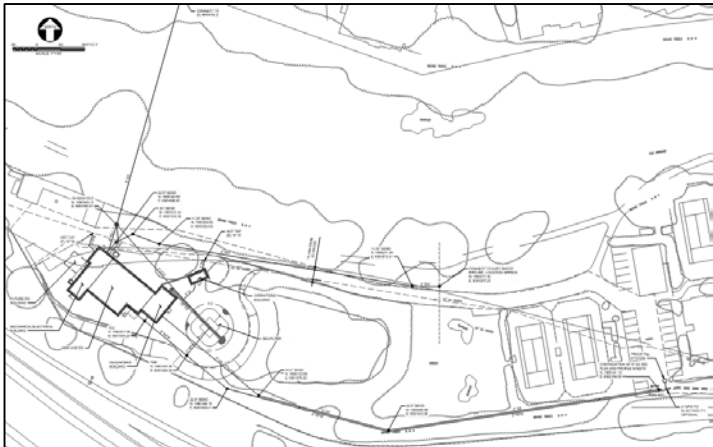

## Design/Build Approach

Design and construction of project elements will be phased for efficiency



# Project Elements

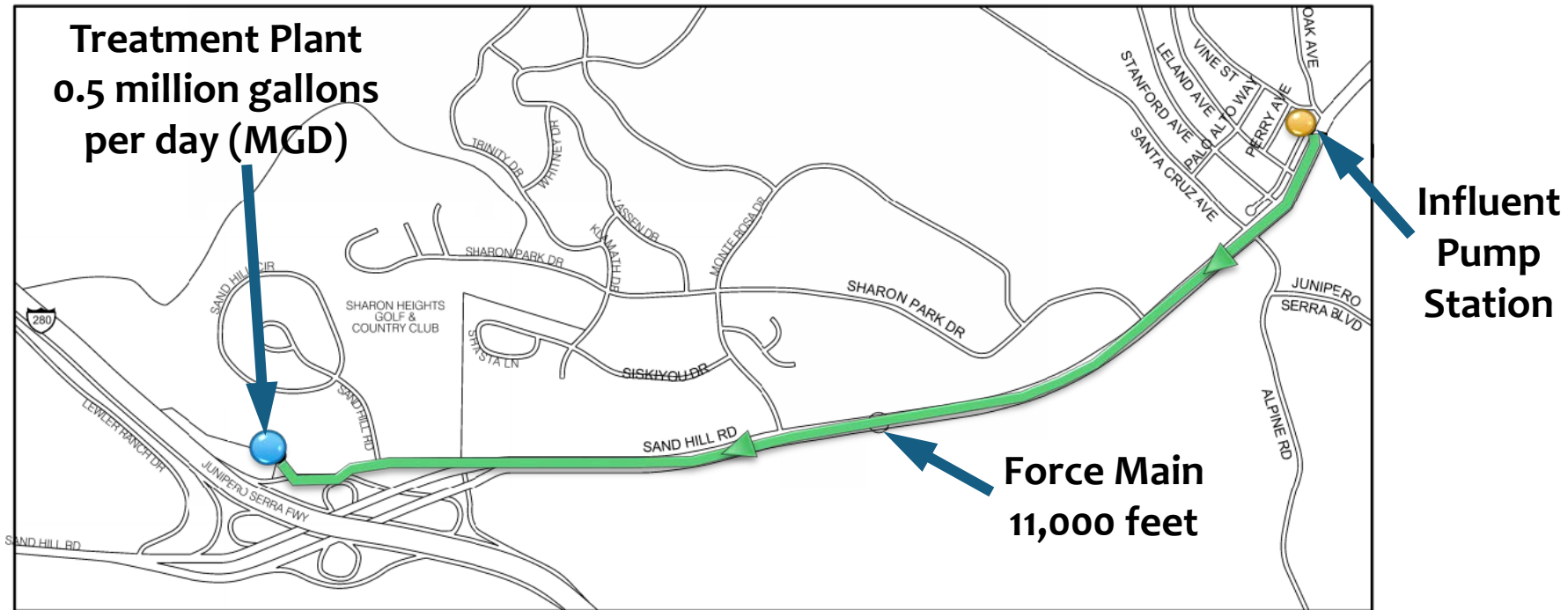

# Treatment Plant – Sharon Heights Golf and Country Club

- Well-screened
- Quiet
- Minimal disturbance to traffic
- Robust odor control
- Meets Menlo Park Fire District requirements
- Easements procured
- Truck fill for utility water
- Future capacity to provide recycled water to SLAC and other users



Irrigated with  
**RECYCLED  
WATER**

Do Not  
Drink  
No Beber



# Pipe Alignment – Sand Hill Road

— Wastewater  
Force Main

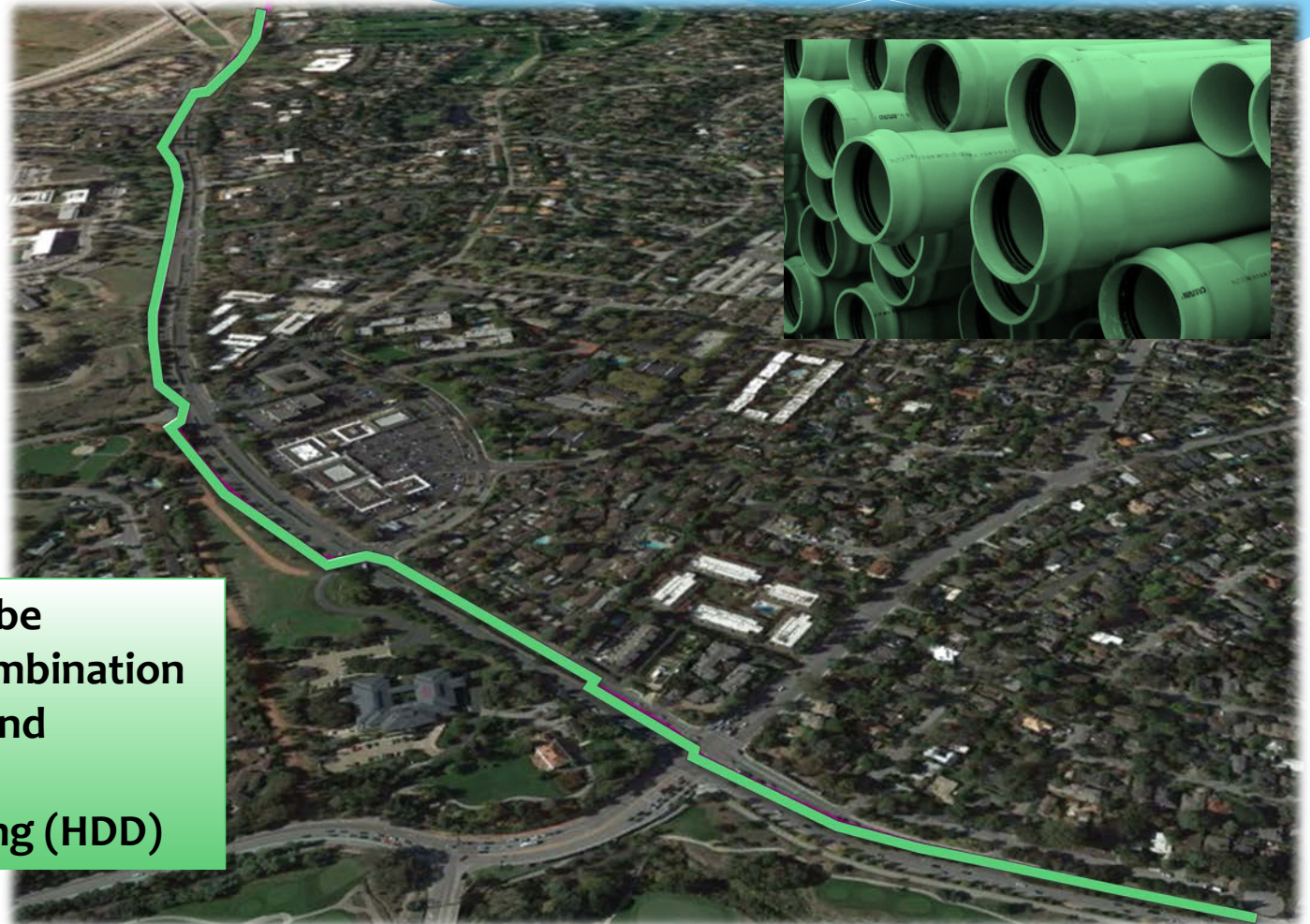

Force main may be installed by a combination of open trench and horizontal directional drilling (HDD)



# Pipe Installation Methods



Open Trench



Trenchless:  
Horizontal Directional Drill (HDD)

# Sand Hill Road Construction

- \* Preliminary alignment coordinated with City Staff
- \* Working with City Staff to determine optimal design criteria to meet mutual goals:
  - \* Minimize construction duration
  - \* Minimize community and traffic impacts
  - \* Minimize environmental footprint
  - \* Maximize road life
  - \* Maximize new road surface and aesthetics
  - \* Cost effective solutions



**WEST BAY**  
SANITARY DISTRICT



# West Bay Sanitary District Recycled Water Project – Sharon Heights

Questions?





\* BACK UP SLIDES (NOT FOR PRESENTATION)

# Paving Requirement

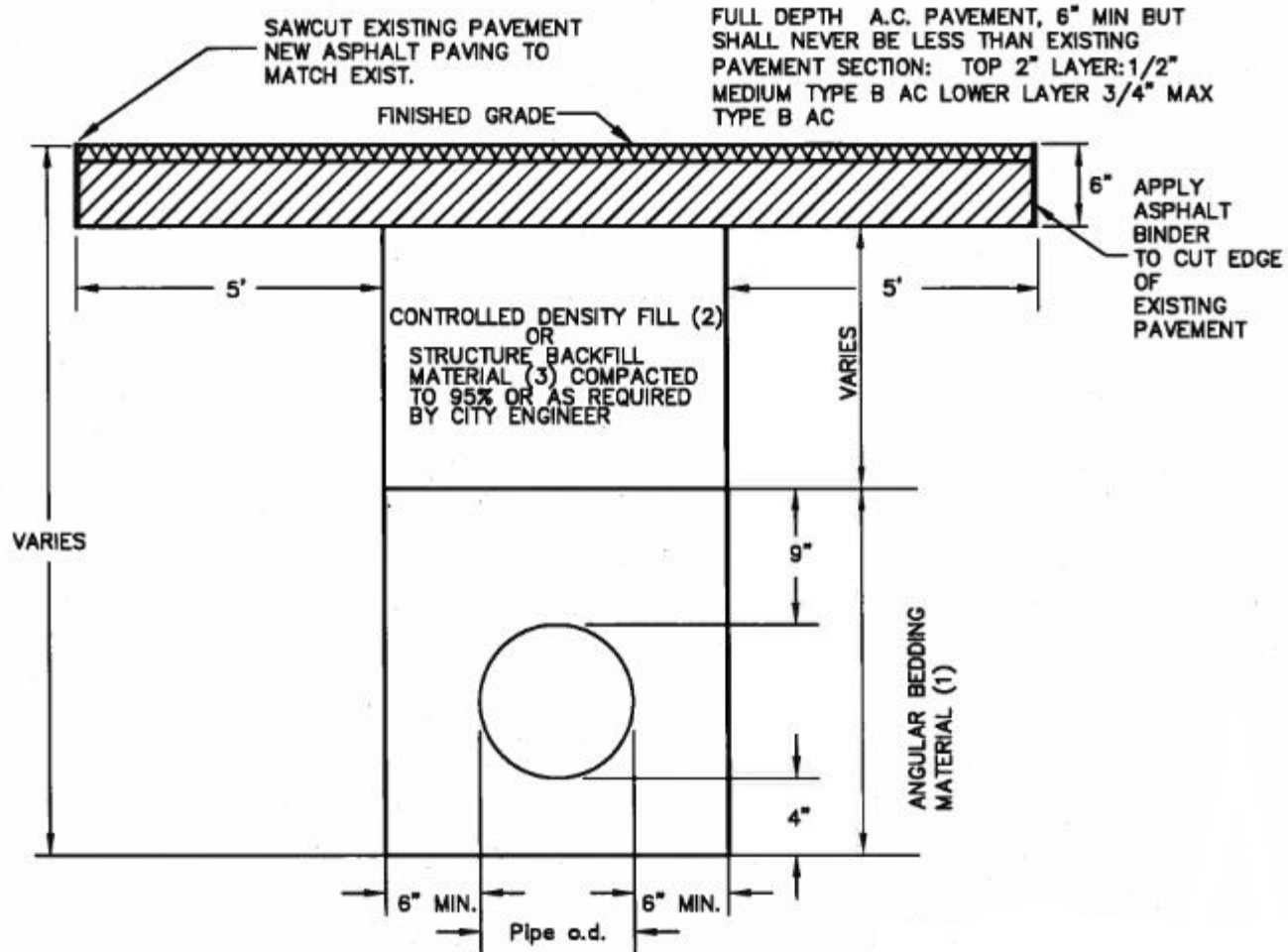

CITY OF MENLO PARK STANDARD TRENCH DETAIL

# Paving Alternative

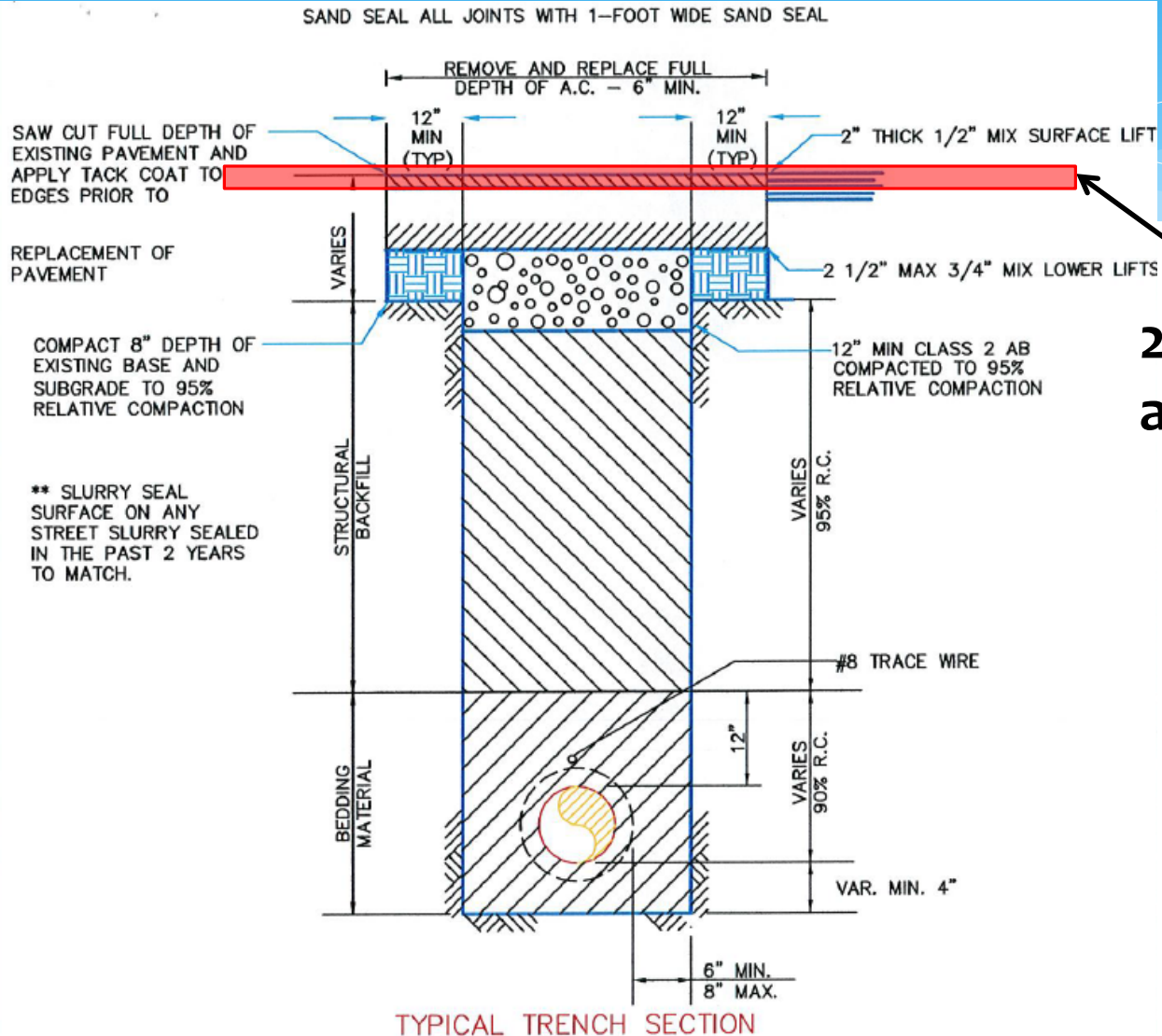

2" AC overlay  
across 2 lanes



# Advantages

- \* Less cost for project - Saves \$0.XXM
- \* More new street for Menlo Park citizens
- \* Eliminates temporary transitions = hella bumps
- \* Conforms to SRF Loan amounts
- \* Saves \$2M in Debt Service cost
- \* Less traffic disruption
- \* Earlier Completion Date



# Pipe Alignment



— Open  
Trench

— HDD

■ HDD  
pit

